



RECEIVED

CITY OF CONCORD

Code Administration

RECEIVED

MAR 29 2019

W

37 Green Street Concord, New Hampshire 03301 • 225.8580 • CODE ADMINISTRATION

APPLICATION TO ERECT A SIGN

Planning Division
Concord, NHPermit # SP039-19

1) Address where sign is to be erected:

79 S State St

2)

Message as shown on sign:

Crisis Center of Central New Hampshire
Marianne A. Fleischman Center For Survivor Support

3)

Property Owner Information

Sign Installer Information

Sign Owner Information

Name > Crisis Center of Central NHAdvantage SignsPaula KelleyAddress > 79 S State St128 Hall St Suite C79 S State StCity/State/ Zip > Concord NH 03301Concord NH 03301Concord NH 03301Phone(s) > 603-225-7376603-224-7446603-225-7376E-mail > paula@cccnh.orgjosh.advantagesigns@gmailpaula@cccnh.org

4) Property Information:

UT26.3

ft

51.3

ft

Zone

Building Frontage

Lot Frontage

5)

☒ New ☐ Relocation ☐ Replacement

Type of Sign:

☒ Freestanding ☐ Monument☐ Wall ☐ Projecting ☐ Window ☐ Awning ☐ Roof ☐ Marquee ☐ Marker

5) Materials to be used:

Granite

6) How & to what is sign supported:

Granite Post to Granite Panel

7) Dimensions of sign:

5'

ft x

2.4'

ft

equals

12

sf

Length

Height

Total

8) Height Overall:

Ground to bottom of sign

3

ft

Ground to top of sign

5.4'

ft

9) Illumination:

☒ None☐ External☐ Internal

Internally illuminated signs are NOT permitted in CVP, IS, UT or any Residential Zones

10) Does sign project over public property or sidewalk?

☒ No☐ Yes* > *

ft

in

11) How far back is leading edge of sign from any curb face?

12'

NOTE: Any applicant for a permit to locate a projecting sign over a public right-of-way, in accordance with this Ordinance, shall file with the Code Administrator, a certificate of insurance indemnifying the City of Concord against any form of liability in a minimum amount as specified by the Finance Director. No permit shall be issued prior to the receipt of said certificate and the permit shall be valid only so long as the certificate remains in effect. The policy shall provide for advance notification to the Code Administrator in the event of cancellation. If the policy should lapse or be cancelled, the applicant shall remove the sign immediately. (Article 28-6-11.a)

12) Does the sign require Design Review?

☒ Yes☐ NoHistoric District Review? ☐ Yes ☐ No

*Design review is required per Article 28-6-9.f, if any of the following apply:

- I. The sign is to be located in a Performance (P) District
- II. The Development requires Major Site Plan Review, Article 28-9-4.d.1
- III. The sign area is greater than the maximum in Column 1 of Table 28-6-9.a
- IV. The sign is the second or third freestanding sign on a lot.

Continued
on back →



ADVANTAGE
Signs

1281 N. St. C. Concord, NH 03301
603-224-7446 v. • 603-224-3888 f.
www.advantagesigns.net

Job Name:

CRISIS CENTER
of
Central New Hampshire

Sales Rep:
Josh Messinger
Drawn By:
BA
Date:
03/08/19
Revision #:
Original

Design © Advantage Signs, Inc. 2019

Sign Types:

PRODUCTION FILE: THIS FILE CAN ONLY BE USED TO
REPRODUCE THE SIGN. IT IS NOT TO BE USED FOR ANY OTHER PURPOSE.

DATE

REVISED

REVISION

APPROVED

DATE

REVISED

REVISION

APPROVED

DATE

REVISED

REVISION

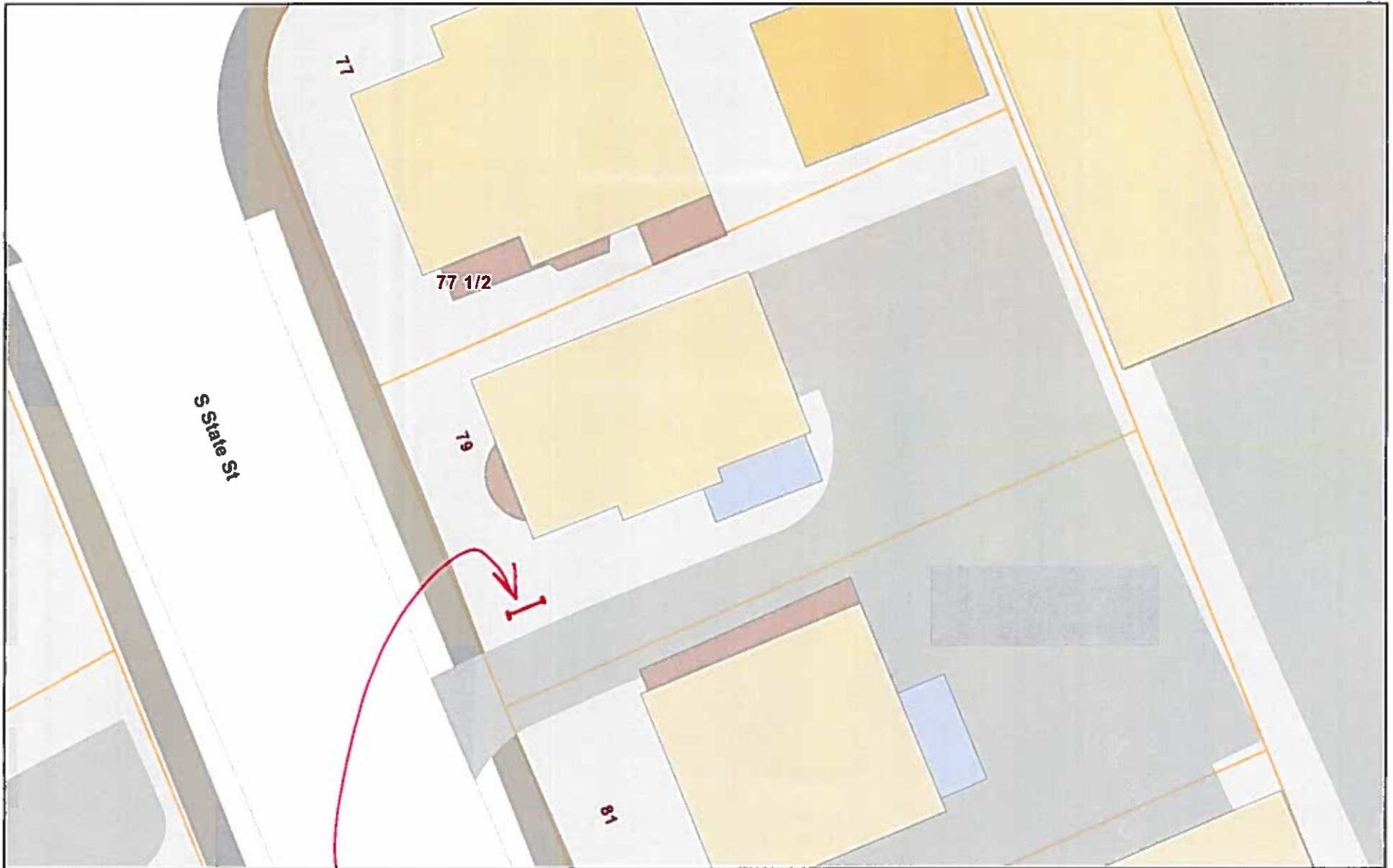

March 29, 2019

*Proposed
Location*

