



CITY OF CONCORD

Code Administration

RECEIVED

37 Green Street • Concord, New Hampshire 03301 • 225.8580 • Fax 225.8586

RECEIVED

FEB 20 2019

CODE ADMINISTRATION

APPLICATION TO ERECT A SIGN

Permit #

- 1) Address where sign is to be erected: 258 SHEEP DAVIS RD
- 2) OSBORNE'S FARM + GARDEN AGWAY

Message as shown on sign:

OSBORNE'S FARM + GARDEN AGWAY

3)	Property Owner Information	Sign Installer Information	Sign Owner Information
Name >	<u>OSBORNE'S PROPERTIES</u>	<u>NH SIGNS</u>	<u>OSBORNE'S AGWAY</u>
Address >	<u>258 SHEEP DAVIS RD</u>	<u>106 GOLD LEDGE AVE</u>	<u>258 SHEEP DAVIS RD</u>
City/State/ Zip >	<u>CONCORD NH</u>	<u>AUBURN NH 03032</u>	
Phone(s) >	<u>225.8561</u>	<u>682.1602 (CELL)</u>	
E-mail >	<u>TOM@OSBORNEAGWAY.COM</u>	<u>PERMITNOW@gmail.com</u>	

- 4) Property Information: GWP 70 ft 502
- Zone Building Frontage Lot Frontage

- 5) Type of Sign: ☒ New ☐ Relocation ☐ Replacement
- ☐ Freestanding ☐ Monument
- ☒ Wall ☐ Projecting ☐ Window ☐ Awning ☐ Roof ☐ Marquee ☐ Marker

- 5) Materials to be used: LEXAN PANEL ALUMINUM CABINET

- 6) How & to what is sign supported: NAIL BOLTED TO WALL

- 7) Dimensions of sign: 66" ft x 48" ft equals 22
- Length Height Total

- 8) Height Overall: Ground to bottom of sign 5' ft Ground to top of sign 9'6" ft

- 9) Illumination: ☐ None ☐ External ☒ Internal Internally illuminated signs are NOT permitted in CVI, IS, UT or any Residential Zones

- 10) Does sign project over public property or sidewalk? ☒ No ☐ Yes* > * ft i

- 11) How far back is leading edge of sign from any curb face? 90'

NOTE: Any applicant for a permit to locate a projecting sign over a public right-of-way, in accordance with this Ordinance, shall file with the Code Administrator, a certificate of insurance indemnifying the City of Concord against any form of liability in a minimum amount as specified by the Finance Director. No permit shall be issued prior to the receipt of said certificate and the permit shall be valid only so long as the certificate remains in effect. The policy shall provide for advance notification to the Code Administrator in the event of cancellation. If the policy should lapse or be cancelled, the applicant shall remove the sign immediately. (Article 28-6-11.a)

- 12) Does the sign require Design Review? ☒ Yes ☐ No Historic District Review? ☐ Yes ☐ No

*Design review is required per Article 28-6-9.f, if any of the following apply:

- The sign is to be located in a Performance (P)-District
- The Development requires Major Site Plan Review, Article 28-9-4.d.1
- The sign area is greater than the maximum in Column 1 of Table 28-6-9.a
- The sign is the second or third freestanding sign on a lot.

Continued
on back →



(1) NEW SF LIGHT BOX
INTERNALLY ILLUMINATED (LED)
22 SQ. FT.



DESIGN • MANUFACTURE • INSTALL • SERVICE
nhsigns.com • 603.437.1200
66 Gold Ledge Avenue, Auburn, NH 03032
FAX 603.437.1222



CLIENT: OSBORNE AGWAY
LOCATION: CONCORD, NH
DATE: 12.29.18

DESIGNER: L. Saville
ACCT. REP: DAN HUTCHINS

☒ DESIGN APPROVED
BY _____ DATE ____ / ____ / 18

REVISION	NOTES	BY	TYPE
1	06/18		
2			
3			

☐ MORE INFORMATION REQUIRED
☐ SURVEY NEEDED FOR:
☐ FINAL DRAWINGS AND PRICING
☐ PERMIT PRODUCTION

Please check if all the necessary information is provided. (including permit fees) Once the permit has been obtained, the client is responsible for obtaining the necessary permits. NH Signs is responsible for obtaining the necessary permits.

BY INSTALLATION. NH SIGNS OWNS THE COPYRIGHT ON ALL ORIGINAL DESIGNS. Reproduction without written permission is prohibited. NH SIGNS DISCLAIMS LIABILITY FOR ANY DAMAGE OR INJURY TO PERSONS OR PROPERTY CAUSED BY THE USE OF ANY PRODUCT OR SERVICE PROVIDED BY NH SIGNS.





RECEIVED CITY OF CONCORD

FEB 21 2019 Code Administration

RECEIVED

FEB 20 2019

37 Green Street • Concord, New Hampshire 03301 • 603-858-1111 • 603-858-1111

Planning Division

CODE ADMINISTRATION

APPLICATION TO ERECT A SIGN

Permit # _____

1) Address where sign is to be erected: 258 SHEEP DAVIS RD

2) Message as shown on sign:

OSBORNE'S FARM + GARDEN AGWAY

	Property Owner Information	Sign Installer Information	Sign Owner Information
Name >	OSBORNE PROPERTIES	NH SIGNS	OSBORNE AGWAY
Address >	258 SHEEP DAVIS RD	66 GOLD LEDGE AVE	258 SHEEP DAVIS RD
City/State/ Zip >	CONCORD NH	AUBURN NH 03032	
Phone(s) >		682-1602 (CELL)	
E-mail >		PERMITNOW@GMAIL.COM	

4) Property Information:

GWP Zone | 52.70 ft Building Frontage | 502 Lot Frontage

5) Type of Sign: ☐ New ☐ Relocation ☒ Replacement
☒ Freestanding ☐ Monument

☐ Wall ☐ Projecting ☐ Window ☐ Awning ☐ Roof ☐ Marquee ☐ Marker

5) Materials to be used:

LEXAN PANEL

6) How & to what is sign supported:

EXISTING CABINET

7) Dimensions of sign:

120" Length x 87.25" Height equals 72.70 Total

8) Height Overall: Ground to bottom of sign 7 ft Ground to top of sign 18 ft

9) Illumination: ☐ None ☐ External ☒ Internal
Internally illuminated signs are NOT permitted in CVT, IS, UT or any Residential Zones

10) Does sign project over public property or sidewalk? ☒ No ☐ Yes* > * ft i

11) How far back is leading edge of sign from any curb face?

30'

NOTE: Any applicant for a permit to locate a projecting sign over a public right-of-way, in accordance with this Ordinance, shall file with the Code Administrator, a certificate of insurance indemnifying the City of Concord against any form of liability in a minimum amount as specified by the Finance Director. No permit shall be issued prior to the receipt of said certificate and the permit shall be valid only so long as the certificate remains in effect. The policy shall provide for advance notification to the Code Administrator in the event of cancellation. If the policy should lapse or be cancelled, the applicant shall remove the sign immediately. (Article 28-6-11.a)

12) Does the sign require Design Review? ☒ Yes ☐ No Historic District Review? ☐ Yes ☐ No

*Design review is **required** per Article 28-6-9.f, if any of the following apply:

- The sign is to be located in a Performance (P) District
- The Development requires Major Site Plan Review, Article 28-9-4.d.1
- The sign area is greater than the maximum in Column 1 of Table 28-6-9.a
- The sign is the second or third freestanding sign on a lot.

Continued
on back →



- PMS 3025 C
- PMS 361 C
- PMS 485 C

87.25"

VO NO
NEED SURVEY

49.50"

120.00"
AMENDED 1.7.19



REMOVE
EXISTING
DIV BAR

**CC BOARD
NO CHANGE**



SERVING NEW ENGLAND
SINCE 1992

DESIGN • MANUFACTURE • INSTALL • SERVICE
nhsigns.com • 603.437.1200
66 Gold Ledge Avenue, Auburn, NH 03032
FAX 603.437.1222



CLIENT: OSBORNE AGWAY
LOCATION: CONCORD, NH
DATE: 12.29.18

DESIGNER: J. Saville
ACCT. REP. DAN HUTCHINS

☒ DESIGN APPROVED
BY _____ DATE / / 16

REVISION	NOTES	BY	TYPE
1	1/3/19		
2	1/7/19		
3			

☐ APPROX INFORMATION
REQUIRED
SURVEY NEEDED FOR:
☐ FINAL DRAWINGS
AND PRICING
☐ PERKS / PROSECUTION

Plans must be to the customer
responsibility to provide
necessary information
to the customer to ensure
the project is completed
to the customer's satisfaction.

© INDIANA HOLDINGS
ANY SIGNING THE COPYRIGHT OF ALL ORIGINAL DESIGNERS
AND/OR OTHERS IS PROTECTED BY LAW AND IS NOT TO BE REPRODUCED OR TRANSMITTED IN ANY FORM OR BY ANY MEANS, ELECTRONIC OR MECHANICAL, INCLUDING PHOTOCOPYING, RECORDING, OR BY ANY INFORMATION STORAGE AND RETRIEVAL SYSTEM, WITHOUT PERMISSION IN WRITING FROM THE COPYRIGHT OWNER.



AGWAY

**OSBORNE'S
FARM & GARDEN**

STILL NEED A TREE
FRESH BATCH JUST IN

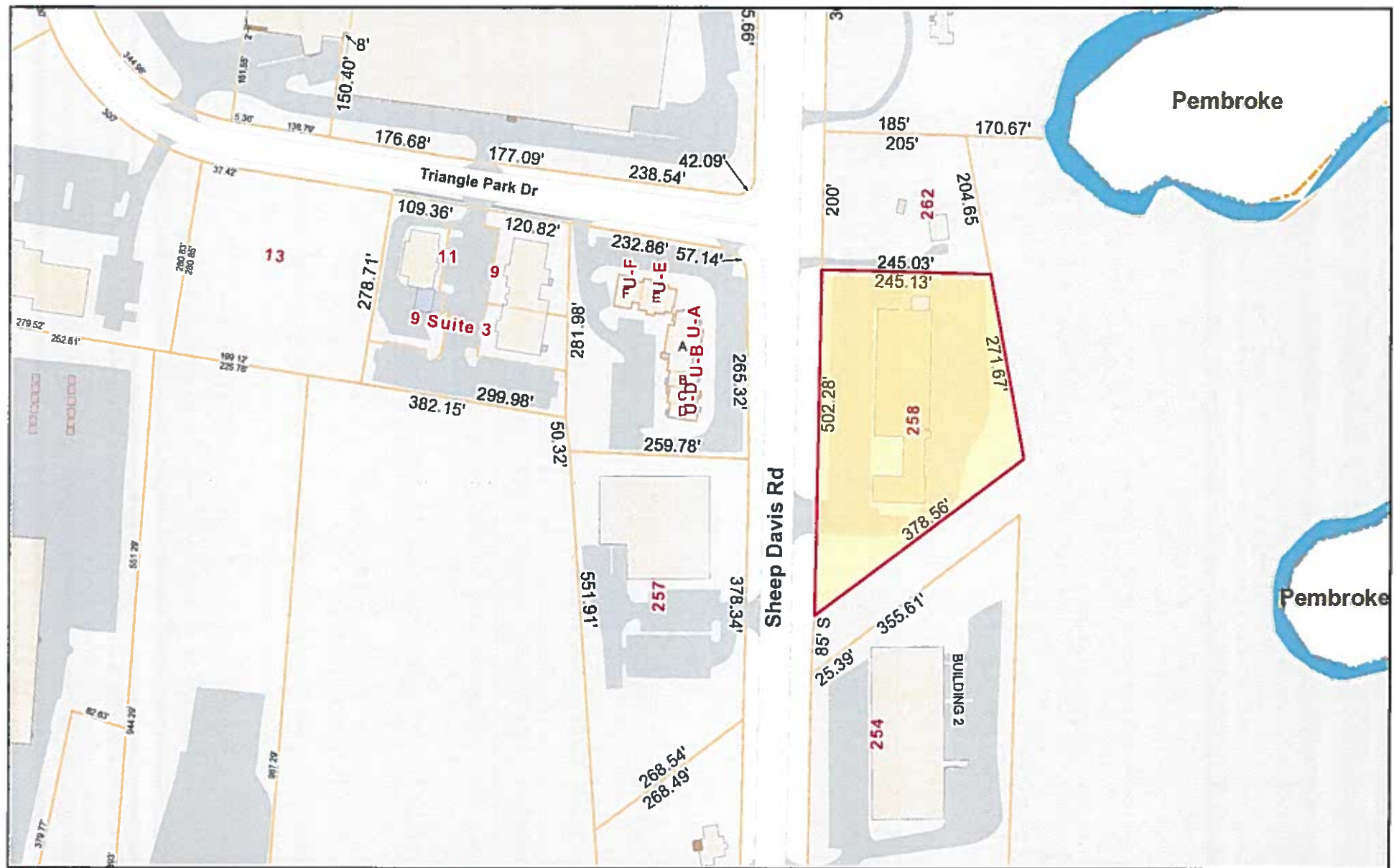

March 1, 2019

