



City of Concord
37 Green St
Concord, NH 03301
www.concordnh.gov

Permit

Permit NO. **SP-0626-2025**

Permit Type: **PLNG - Sign Or Awning**

Work Classification: **Sign**

Permit Status: **Fees Due**

Issue Date:

Expiration:

Location Address

80 Storrs St, Concord, NH

Parcel Number

100031

Contacts

Brixmor Property Group
450 Lexington Ave, FL 13, New York, NY 100173956
(781)313-2004 James.Mientkiewica@brixmor.com

Owner

MARK CUSSON
15 Cross rd, HOOKSETT, NH 03106
(603)623-7445

Applicant

nhsinguy@gmail.com

matt castro
(619)334-3303 Matt@blairsign.net

Contractor

Description: Burlington-A- Main Front Wall sign.

Valuation: \$0.00

Total Sq Feet: 0.00

Inspection Requests:

603-225-8580

Fees	Amount
CD - Application for Sign	\$30.00
CD - Sign application PB review	\$30.00
CD - Sign Permit Fee SF Cost	\$517.50
Total:	\$577.50

Payments	Amt Paid
Total Fees	
Amount Due:	

Available Inspections:	
Inspection Type	
Zoning Code Enforcement	0
CD - Final Sign	180

Applicant certifies that all the information given is correct and true and that all work performed will comply with applicable City of Concord and State of New Hampshire, Building and Fire Codes, Ordinances, Laws and Regulations.

Additional Information

Sign Dimensions: 7.6' x 30.25'

Total Square Feet: 230

Is this Sign:: Replacement

Is this sign illuminated?: Yes

If Yes, pick one: Internal

Sign Projects over Public Right-of-Way: No

SignPermitAddtlInfo: CONDITIONS OF PERMIT • If a sign projects over a sidewalk or public way, it is mandatory for the owner to furnish a Certificate of Insurance in an amount not less than \$1,000,000, indemnifying the City of Concord against any form of liability. The policy shall provide for advance notification to the Code Administrator in the event of cancellation. If the policy should lapse or be canceled, the owner shall remove the sign immediately. • The Code Administrator or his authorized agent may revoke this permit at any time. • No portable signs shall be placed in the public right of way. • All signs shall conform to all requirements of the Zoning Ordinance for the district in which it is located. • All signs must be constructed of materials and methods conforming to the minimum standards of the City of Concord Building Code. • All signs which are illuminated or supplied with electric power must be UL listed and installed in accordance with the City of Concord Electrical Code and shall require separate electrical permits. • Sign permits are not transferrable in case of change of ownership, relocation, or alteration of size or structure.

Zoning District: OCP

Issued By: Brian Tremblay

Date



City of Concord
37 Green St
Concord, NH 03301
www.concordnh.gov

Permit

Permit NO. **SP-0627-2025**

Permit Type: **PLNG - Sign Or Awning**

Work Classification: **Sign**

Permit Status: **Fees Due**

Issue Date:

Expiration:

Location Address

80 Storrs St, Concord, NH

Parcel Number

100031

Contacts

Owner
Brixmor Property Group
450 Lexington Ave, FL 13, New York, NY 100173956
(781)313-2004 James.Mientkiewica@brixmor.com

Applicant
MARK CUSSON
15 Cross rd, HOOKSETT, NH 03106
(603)623-7445 nhsinguy@gmail.com

Applicant
MARK CUSSON
15 Cross rd, HOOKSETT, NH 03106
(603)623-7445 nhsinguy@gmail.com

Project Manager/Contractor
matt castro
(619)334-3303 Matt@blairsign.net

Description: Burlington-B-Logo sign on side walk wall under main sign

Valuation: **\$0.00**

Total Sq Feet: **0.00**

Inspection Requests:

603-225-8580

Fees	Amount
CD - Application for Sign	\$30.00
CD - Sign application PB review	\$30.00
CD - Sign Permit Fee SF Cost	\$105.75
Total:	\$165.75

Payments	Amt Paid
Total Fees	
Amount Due:	

Available Inspections:

Inspection Type	
Zoning Code Enforcement	0
CD - Final Sign	180

Applicant certifies that all the information given is correct and true and that all work performed will comply with applicable City of Concord and State of New Hampshire, Building and Fire Codes, Ordinances, Laws and Regulations.

Additional Information

Sign Dimensions: 6' 10" x 6' 10"

Total Square Feet: 47

Is this Sign:: Replacement

Is this sign illuminated?: Yes

If Yes, pick one: Internal

Sign Projects over Public Right-of-Way: No

SignPermitAddtlInfo: CONDITIONS OF PERMIT • If a sign projects over a sidewalk or public way, it is mandatory for the owner to furnish a Certificate of Insurance in an amount not less than \$1,000,000, indemnifying the City of Concord against any form of liability. The policy shall provide for advance notification to the Code Administrator in the event of cancellation. If the policy should lapse or be canceled, the owner shall remove the sign immediately. • The Code Administrator or his authorized agent may revoke this permit at any time. • No portable signs shall be placed in the public right of way. • All signs shall conform to all requirements of the Zoning Ordinance for the district in which it is located. • All signs must be constructed of materials and methods conforming to the minimum standards of the City of Concord Building Code. • All signs which are illuminated or supplied with electric power must be UL listed and installed in accordance with the City of Concord Electrical Code and shall require separate electrical permits. • Sign permits are not transferrable in case of change of ownership, relocation, or alteration of size or structure.

Zoning District: OCP

Issued By: Brian Tremblay

Date



City of Concord
37 Green St
Concord, NH 03301
www.concordnh.gov

Permit

Permit NO. **SP-0628-2025**

Permit Type: **PLNG - Sign Or Awning**

Work Classification: **Sign**

Permit Status: **Fees Due**

Issue Date:

Expiration:

Location Address

80 Storrs St, Concord, NH

Parcel Number

100031

Contacts

Owner
Brixmor Property Group
450 Lexington Ave, FL 13, New York, NY 100173956
(781)313-2004 James.Mientkiewica@brixmor.com

Applicant
MARK CUSSON
15 Cross rd, HOOKSETT, NH 03106
(603)623-7445 nhsinguy@gmail.com

Applicant
MARK CUSSON
15 Cross rd, HOOKSETT, NH 03106
(603)623-7445 nhsinguy@gmail.com

Project Manager/Contractor
matt castro
(619)334-3303 Matt@blairsign.net

Description: Burlington-C- Store sign on south east elevation (facing I-93)

Valuation: **\$0.00**

Total Sq Feet: **0.00**

Inspection Requests:

603-225-8580

Fees	Amount
CD - Application for Sign	\$30.00
CD - Sign application PB review	\$30.00
CD - Sign Permit Fee SF Cost	\$135.00
Total:	\$195.00

Payments	Amt Paid
Total Fees	
Amount Due:	

Available Inspections:

Inspection Type	
Zoning Code Enforcement	0
CD - Final Sign	180

Applicant certifies that all the information given is correct and true and that all work performed will comply with applicable City of Concord and State of New Hampshire, Building and Fire Codes, Ordinances, Laws and Regulations.

Additional Information

Sign Dimensions: 3' 10.5" x 15' 5"

Total Square Feet: 60

Is this Sign:: Replacement

Is this sign illuminated?: Yes

If Yes, pick one: Internal

Sign Projects over Public Right-of-Way: No

SignPermitAddtlInfo: CONDITIONS OF PERMIT • If a sign projects over a sidewalk or public way, it is mandatory for the owner to furnish a Certificate of Insurance in an amount not less than \$1,000,000, indemnifying the City of Concord against any form of liability. The policy shall provide for advance notification to the Code Administrator in the event of cancellation. If the policy should lapse or be canceled, the owner shall remove the sign immediately. • The Code Administrator or his authorized agent may revoke this permit at any time. • No portable signs shall be placed in the public right of way. • All signs shall conform to all requirements of the Zoning Ordinance for the district in which it is located. • All signs must be constructed of materials and methods conforming to the minimum standards of the City of Concord Building Code. • All signs which are illuminated or supplied with electric power must be UL listed and installed in accordance with the City of Concord Electrical Code and shall require separate electrical permits. • Sign permits are not transferrable in case of change of ownership, relocation, or alteration of size or structure.

Zoning District: OCP

Issued By: Brian Tremblay

Date



City of Concord
37 Green St
Concord, NH 03301
www.concordnh.gov

Permit

Permit NO. **SP-0629-2025**

Permit Type: **PLNG - Sign Or Awning**

Work Classification: **Sign**

Permit Status: **Fees Due**

Issue Date:

Expiration:

Location Address

80 Storrs St, Concord, NH

Parcel Number

100031

Contacts

Owner
Brixmor Property Group
450 Lexington Ave, FL 13, New York, NY 100173956
(781)313-2004 James.Mientkiewica@brixmor.com

Applicant
MARK CUSSON
15 Cross rd, HOOKSETT, NH 03106
(603)623-7445 nhsinguy@gmail.com

Applicant
MARK CUSSON
15 Cross rd, HOOKSETT, NH 03106
(603)623-7445 nhsinguy@gmail.com

Project Manager/Contractor
matt castro
(619)334-3303 Matt@blairsign.net

Description: Burlington D- Store sign, South Elevation(bump-out)

Valuation: **\$0.00**

Total Sq Feet: **0.00**

Inspection Requests:

603-225-8580

Fees	Amount
CD - Application for Sign	\$30.00
CD - Sign application PB review	\$30.00
CD - Sign Permit Fee SF Cost	\$74.25
Total:	\$134.25

Payments	Amt Paid
Total Fees	
Amount Due:	

Available Inspections:

Inspection Type	
Zoning Code Enforcement	0
CD - Final Sign	180

Applicant certifies that all the information given is correct and true and that all work performed will comply with applicable City of Concord and State of New Hampshire, Building and Fire Codes, Ordinances, Laws and Regulations.

Additional Information

Sign Dimensions: 2' 8.25" x 12' 4"

Total Square Feet: 33

Is this Sign:: Replacement

Is this sign illuminated?: Yes

If Yes, pick one: Internal

Sign Projects over Public Right-of-Way: No

SignPermitAddtlInfo: CONDITIONS OF PERMIT • If a sign projects over a sidewalk or public way, it is mandatory for the owner to furnish a Certificate of Insurance in an amount not less than \$1,000,000, indemnifying the City of Concord against any form of liability. The policy shall provide for advance notification to the Code Administrator in the event of cancellation. If the policy should lapse or be canceled, the owner shall remove the sign immediately. • The Code Administrator or his authorized agent may revoke this permit at any time. • No portable signs shall be placed in the public right of way. • All signs shall conform to all requirements of the Zoning Ordinance for the district in which it is located. • All signs must be constructed of materials and methods conforming to the minimum standards of the City of Concord Building Code. • All signs which are illuminated or supplied with electric power must be UL listed and installed in accordance with the City of Concord Electrical Code and shall require separate electrical permits. • Sign permits are not transferrable in case of change of ownership, relocation, or alteration of size or structure.

Zoning District: OCP

Issued By: Brian Tremblay

Date

EXTERIOR SIGN DESIGN STUDY

THIS EXHIBIT IS FOR SIGN SCOPE ONLY (NOT EXTERIOR ELEVATION SCOPE) - MODIFIED EXISTING FACADE



nickZAHNER
9932 Prospect Ave
Studio 137
Santee, CA 92071
(619) 792-1600

nickz@blairsign.net
www.blairsign.net

*Retail branding for
the built environment*

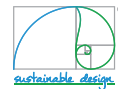

JULY 11, 2025 | REV. 8

CAPITAL PLAZA
50 Storrs Street,
Concord, NH 03301

Property Evaluation Report: Sign Code Research

Code research is done to the best of our ability by confirming with city and obtaining code in writing – nothing is 100% guaranteed until permits are in hand.

I. Location

City/St./Zip: **50 Storrs Street**

City/St./Zip: **Concord, NH 03301**

Shopping Center Name: **Capital City Shopping Center**

Former Tenant: **Burlington**

II. Exterior Signage

This report is based upon the

- city/county sign code **Zone/District: OCP / Opportunity Corridor Performance District**
- Master Sign Program: **No**

A. Building Wall Sign(s)

- Total Quantity Allowed per tenant: **Three (3)**
- Total Quantity Allowed per elevation: **Three (3)**
- Sq. Ft. Allowed (storefront/primary sign): **For each building frontage, a maximum of three (3) building signs of any type are permitted provided that the total area of all signs does not exceed the lesser of the following: a. an area equal to one (1) square foot per linear foot of building frontage, or 150 sf.**
- Sq. Ft for bldg. sides/rear: **Follow formula above**
- Sq. Ft. Allowed/Aggregate: **Follow formula above**
- Transferable: **No**
- Max. Height Allowed: **NTE top of building wall**
- Max. Width Allowed: **Not specified**
- How is sq ft measured?: **Box Cabinet/Entire letter set; including backer panel.**

C. Boxed heart logo:

- Is it counted as part of the primary storefront sign? **Yes**
-Follow formula above

D. Pylon Sign(s) & D. Monument Sign(s)

- Qty Allowed: **Existing**

Sq.Ft. Allowed: **N/A**

III. Window Graphics

- Allowed: **Yes (Only temporary)**
- Total Area Allowed per window: **30% window area, requires permit**
- Logo's: **See above**
- Marketing Materials: **See above**
- Frosted or tinting: **See above**

IV. Temporary Signage

A. Banners: **Allowed, 15 sq. f.t max. Banners displaying an "Open" or "Sale" message, provided that only one (1) of said banners shall be permitted per principal use. Requires permit**

B. Construction Signs: **Allowed, 32sq ft. max. shall not be erected prior to the issuance of a building permit, and shall be removed upon discontinuance of construction or within thirty (30) days after the issuance of the Certificate of Occupancy.**

C. Adware signs: **Allowed, 15 sq. f.t max. Banners displaying an "Open" or "Sale" message, provided that only one (1) of said banners shall be permitted per principal use. Requires permit.**

IV. Permit Procedure

A. Permit: **Process time is 30 days. LL must approve before sign package before submitting permits. Final inspection needs the installer to be present.**

- Over-the-counter **No**
- Design Review **No**

B. Variance: **Are allowed. Processing time is 60-90 days. Call to schedule a meeting.**

- Probability of variance approval (84" set): **50%**
- Probability of variance approval (72" set): **50%**

C. Spoke with **Alec Bass**

In the **Planning** Department.

Contact : **(603) 225-8515, ABass@ConcordNH.gov**

D. Form of Landlord Approval for permits

Letterhead and Signed Plans

V. Additional Information

A. Notes: **N/A**

VI. Restrictive Issues: N/A

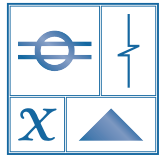

**BLAIR SIGN
PROGRAMS**

(619) 792-1600
www.blairsign.net
CA License #677503

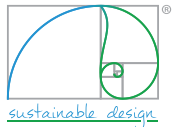

CLIENT:

Burlington

PROJECT:

Concord, NH #479
Design Study

ADDRESS:

50 Storrs Street
Concord, NH 03301

DATE:

01/02/2024

DESIGNER:

E. Cameron

REVISIONS:

REVISIONS:	BY:
1: 03/21/2024	EC
2: 09/20/2024	EC
3: 04/04/2025	EC
4: 05/13/2025	VZ
5: 06/10/2025	VZ
6: 06/13/2025	VZ
7: 06/30/2025	VZ
8: 07/11/2025	VZ

CODE REPORT

© 2024 BLAIR SIGN PROGRAMS



SITE PLAN

NOTES:
The design contents of this document are for evaluation only.
Final design to be determined.

SECTION I: BUILDING SIGNS			
SIGN TYPE	SIGN DESCRIPTION	ALLOWED	PROPOSED
A	Channel Letters	58.5 Sq. Ft.	230 Sq. Ft.
B	"Heart-B" Logo	N/A	47 Sq. Ft.
C	Channel Letters	58.5 Sq. Ft.	33 Sq. Ft.
D	Channel Letters	N/A	60 Sq. Ft.
BUILDING SIGN TOTAL		117 Sq. Ft.	370 Sq. Ft.
SECTION II: WINDOW			
V.1	Window Film		
SECTION III: CONSTRUCTION			
A	Channel Letter & Tag Line Detail		
A	WOWI Detail		
C	Channel Letter Detail		
D	Channel Letter Detail		
D	Tag Line Detail		
D	WOWI Detail		

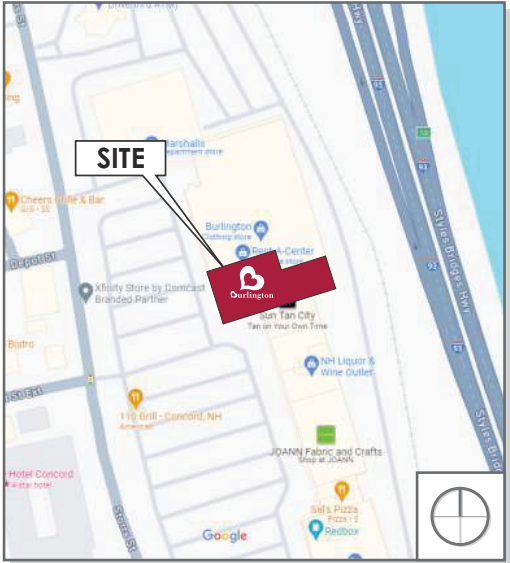

VICINITY MAP

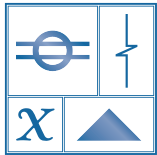

BLAIR SIGN
PROGRAMS

(619) 792-1600
www.blairsign.net
CA License #677503

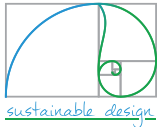

CLIENT:

Burlington

PROJECT:

Concord, NH #479
Design Study

ADDRESS:

50 Storrs Street
Concord, NH 03301

DATE:

01/02/2024

DESIGNER:

E. Cameron

REVISIONS:

REVISIONS:	BY:
1: 03/21/2024	EC
2: 09/20/2024	EC
3: 04/04/2025	EC
4: 05/13/2025	VZ
5: 06/10/2025	VZ
6: 06/13/2025	VZ
7: 06/30/2025	VZ
8: 07/11/2025	VZ

INDEX, SITE PLAN,
VICINITY MAP

© 2024 BLAIR SIGN PROGRAMS



EXISTING ELEVATION

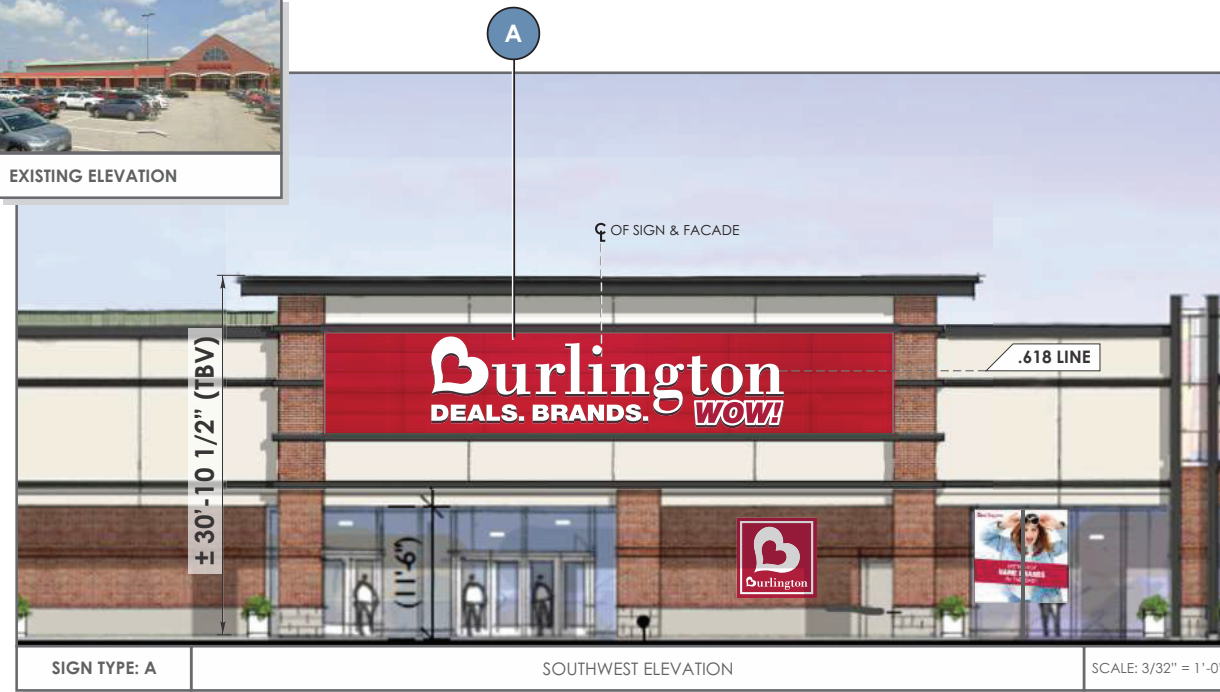

SIGN TYPE: A

SOUTHWEST ELEVATION

SCALE: 3/32" = 1'-0"



SIGN TYPE: A

59" ILLUMINATED CHANNEL LETTERS W/ TAG LINE AND WOW!

120v/ 20 amp

230 SQ. FT.

SCALE: 3/16" = 1'-0"

SCOPE OF WORK - SIGN(S) TYPE A

Scope:

Manufacture and install internally illuminated, face-lit channel letters and face-lit, halo-lit WOW! letters as shown.

"Burlington, DEALS. BRANDS." ID letters:

Body-

5" deep, fabricated aluminum with .040" returns and backs. Interior metal surfaces to be white, reflective finish. Exterior metal surfaces to be black, matte finish.

Faces-

3/16", translucent white Lexan. Faces to be attached with 1" black trim-cap.

Illumination-

Illumination to be provided by 6500K, white LED's with remote power supplies with hook-up to incoming power supplied by others.

WOW!:

Body-

3" deep, fabricated aluminum with .090" returns and 3/16" clear Lexan backs. Interior metal surfaces to be mill finish. Exterior returns to be black, matte finish.

Face-

3/16" White Lexan face w/ 1" black trim-cap.

WOW! Letters-

1/2", thick clear acrylic w/ frosted edges w/ translucent red vinyl (custom color, PMS 207c) applied 1st surface.

Illumination-

Illumination to be face-lit and halo-lit provided by 6500K, white LED's with remote power supplies.

Installation:

Install as shown and as per specifications provided by this document.

Incoming Power/Access:

Incoming "house" power to be provided by others with reasonable access within 6 feet of planned.

Notes:

All dimensions, site and installation conditions, including access and attachment methods, etc. to be verified by field survey and approved by Burlington prior to installation.

Actual colors may vary from colors shown on your monitor or printed materials.

The design contents of this document are for evaluation only. Final design to be determined.

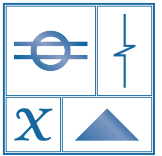

BLAIR SIGN
PROGRAMS

(619) 792-1600
www.blairsign.net
CA License #677503

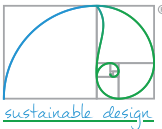

CLIENT:

Burlington

PROJECT:

Concord, NH #479
Design Study

ADDRESS:

50 Storrs Street
Concord, NH 03301

DATE:

01/02/2024

DESIGNER:

E. Cameron

REVISIONS:

REVISIONS:	BY:
1: 03/21/2024	EC
2: 09/20/2024	EC
3: 04/04/2025	EC
4: 05/13/2025	VZ
5: 06/10/2025	VZ
6: 06/13/2025	VZ
7: 06/30/2025	VZ
8: 07/11/2025	VZ

SIGN(S) TYPE: A

SECTION I
SHEET 1

© 2024 BLAIR SIGN PROGRAMS



EXISTING ELEVATION



SIGN TYPE: B

SOUTHWEST ELEVATION

SCALE: 3/32" = 1'-0"



END VIEW

SIGN TYPE: B

NON-ILLUMINATED "HEART-B" LOGO ON BACKER PANEL

47 SQ. FT.

SCALE: 3/8" = 1'-0"

SCOPE OF WORK - SIGN(S) TYPE B

Scope:

Manufacture and Install:

(1) One non-illuminated "Heart-B" logo as shown.

"Heart-B" Logo:

Backer Panel

.090" Aluminum panel painted to match PMS 207c, satin finish on face and returns.

Flat Cut Out

1/2" thick FCO clear acrylic painted white, satin finish on face and returns. (TBV)

Installation-

(TBV)

Notes:

All dimensions, site and installation conditions, including access and attachment methods, etc. to be verified by field survey and approved by Burlington prior to installation.

Actual colors may vary from colors shown on your monitor or printed materials.

The design contents of this document are for evaluation only. Final design to be determined.

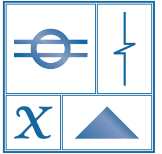

BLAIR SIGN
PROGRAMS

(619) 792-1600
www.blairsign.net
CA License #677503

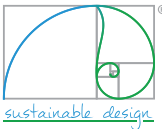

CLIENT:

Burlington

PROJECT:

Concord, NH #479
Design Study

ADDRESS:

50 Storrs Street
Concord, NH 03301

DATE:

01/02/2024

DESIGNER:

E. Cameron

REVISIONS:

REVISIONS:	BY:
1: 03/21/2024	EC
2: 09/20/2024	EC
3: 04/04/2025	EC
4: 05/13/2025	VZ
5: 06/10/2025	VZ
6: 06/13/2025	VZ
7: 06/30/2025	VZ
8: 07/11/2025	VZ

SIGN(S) TYPE: B

SECTION I SHEET 2



EXISTING ELEVATION

C

24'-10"

Burlington

ULTA
BEAUTY

SIGN TYPE: C

NORTHEAST ELEVATION

SCALE: 1/8" = 1'-0"

12' - 4"

2' - 8 1/4" O.A.H.

24"

Burlington

12 3/4"

SIGN TYPE: C

24" ILLUMINATED CHANNEL LETTERS

120v/ 5 amp

33 SQ. FT.

SCALE: 1/2" = 1'-0"

SCOPE OF WORK - SIGN(S) TYPE C

Scope:

Manufacture and install internally illuminated, face-lit channel letters as shown.

"Burlington" ID letters:

Body-

5" deep, fabricated aluminum with .040" returns and backs. Interior metal surfaces to be white, reflective finish. Exterior metal surfaces to be black, matte finish.

Faces-

3/16", clear acrylic with 3M 3635-222, perforated black vinyl applied first surface and, 3M Diffuser, 30%, applied second surface. Faces to be attached with 1" black trim-cap.

Illumination-

Illumination to be provided by 6500k, white LED's with remote power supplies..

Installation-

Install as shown and as per specifications provided by this document.

Incoming Power/Access:

The incoming "house" power is to be provided by others with reasonable access within 6 feet of planned power supply location(s) and/or as noted by this document.

Notes:

All dimensions, site and installation conditions, including access and attachment methods, etc. to be verified by field survey and approved by Burlington prior to installation.

Actual colors may vary from colors shown on your monitor or printed materials.

The design contents of this document are for evaluation only. Final design to be determined.

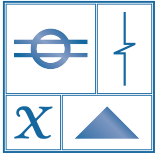

BLAIR SIGN
PROGRAMS

(619) 792-1600

www.blairsign.net

CA License #677503

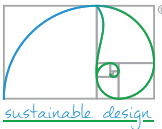

CLIENT:

Burlington

PROJECT:

Concord, NH #479
Design Study

ADDRESS:

50 Storrs Street
Concord, NH 03301

DATE:

01/02/2024

DESIGNER:

E. Cameron

REVISIONS:

REVISIONS:	BY:
1: 03/21/2024	EC
2: 09/20/2024	EC
3: 04/04/2025	EC
4: 05/13/2025	VZ
5: 06/10/2025	VZ
6: 06/13/2025	VZ
7: 06/30/2025	VZ
8: 07/11/2025	VZ

SIGN(S) TYPE: C

SECTION I
SHEET 3

© 2024 BLAIR SIGN PROGRAMS

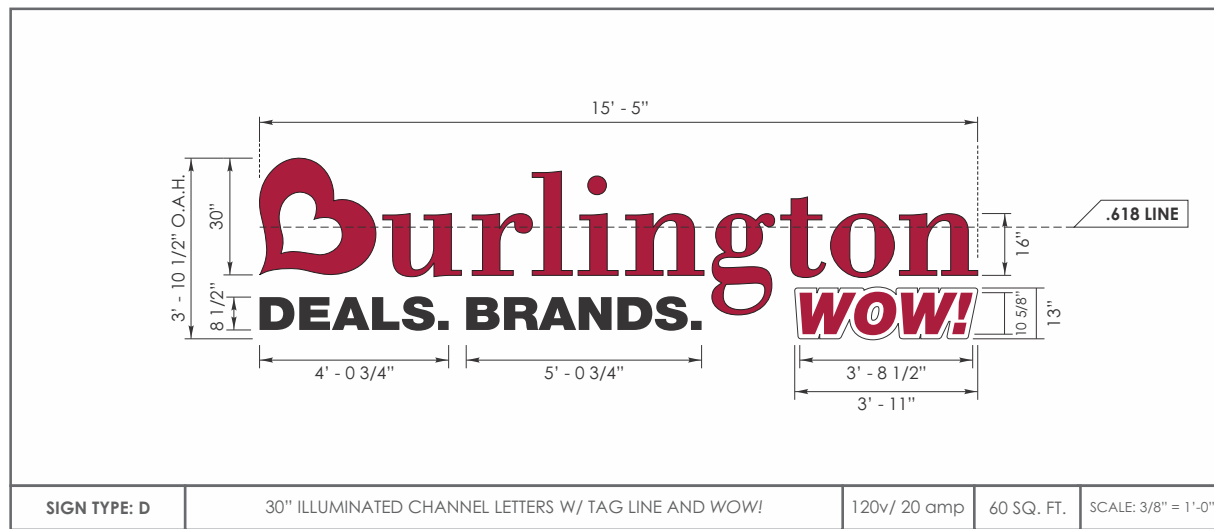

Notes:
All dimensions, site and installation conditions, including access and attachment methods, etc. to be verified by field survey and approved by Burlington prior to installation.
Actual colors may vary from colors shown on your monitor or printed materials.
The design contents of this document are for evaluation only. Final design to be determined.



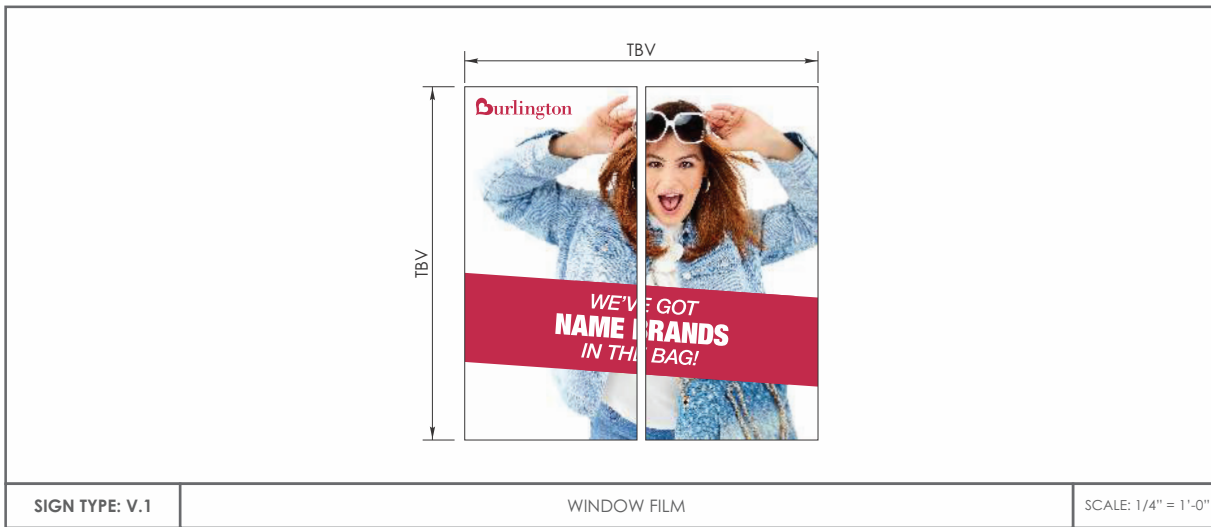

SCOPE OF WORK - SIGN(S) TYPE V.1

Scope:

Manufacture and install window film as shown.

Window Film:

Film-

3M printable dual-color perforated film digitally printed w/ UV inks.

Install-

Apply 1st surface.

Note: Does not cover mullions.

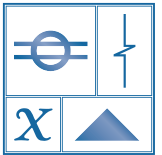

**BLAIR SIGN
PROGRAMS**

(619) 792-1600

www.blairsign.net

CA License #677503

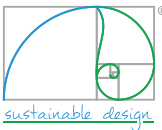

CLIENT:

Burlington

PROJECT:

Concord, NH #479

Design Study

ADDRESS:

50 Storrs Street

Concord, NH 03301

DATE:

01/02/2024

DESIGNER:

E. Cameron

REVISIONS:

REVISIONS:	BY:
1: 03/21/2024	EC
2: 09/20/2024	EC
3: 04/04/2025	EC
4: 05/13/2025	VZ
5: 06/10/2025	VZ
6: 06/13/2025	VZ
7: 06/30/2025	VZ
8: 07/11/2025	VZ

SIGN(S) TYPE: V.1

**SECTION II
SHEET 5**

© 2024 BLAIR SIGN PROGRAMS

Notes:

All dimensions, site and installation conditions, including access and attachment methods, etc. to be verified by field survey and approved by Burlington prior to installation.

Actual colors may vary from colors shown on your monitor or printed materials.



ASSEMBLED VIEW

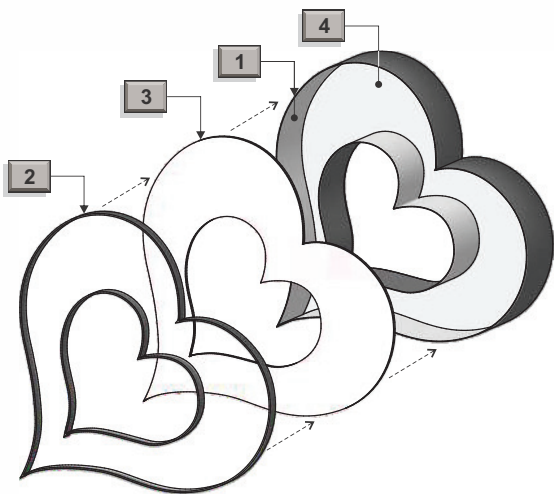

EXPLODED VIEW

WALL CONSTRUCTION:
NICHHA Architectural
wall panels fastened to
sheathing over 10" metal
studs over existing wall

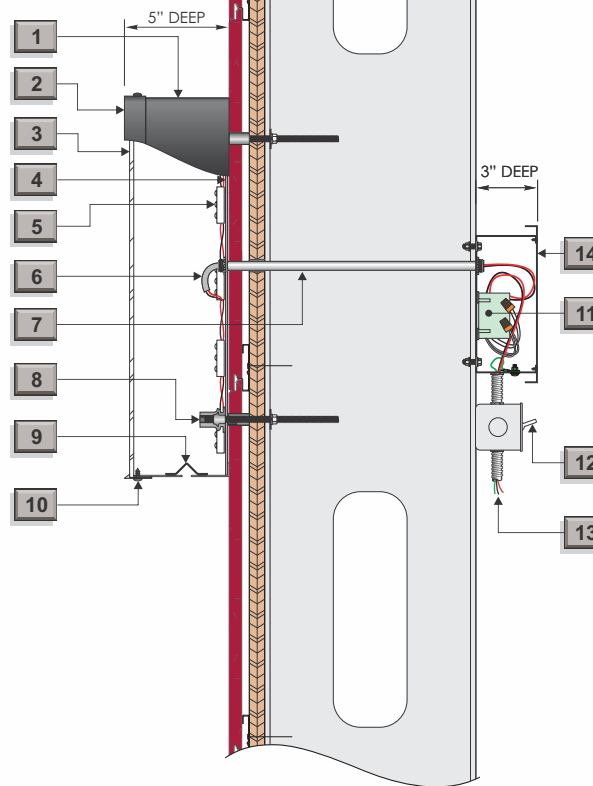

TYPICAL SECTION

1	.040" aluminum returns. Interior metal surfaces to be white, reflective finish. Exterior metal surfaces to be black, matte finish.
2	1" black trim-cap
3	3/16", white Lexan faces.
4	.040" aluminum back. Interior metal surfaces to be white, reflective finish. Exterior metal surfaces to be black, matte finish.
5	White 6500k led modules (Sloan)
6	Exterior jacketed cable, UL listed (6' whip, each tag line letter)
7	1/2" aluminum pass-through, UL listed
8	Steel flange knurled rivet nut 1/4-20 with nuts, washers, 12" by 1/4" threaded rod w/ spacers, (min. eight (8) per "B", min. four (4) each other letters)
9	1/4" weep-hole with angled light-shield baffle
10	Stainless steel, pan-head screw painted to match trim-cap
11	Power supply with SNAP 2 P/S box, part no. 980054c, UL listed
12	Disconnect switch, UL listed
13	Incoming power, provided by others
14	SNAP 2 Power supply box shown. Use fabricated aluminum wire way when wires are in view of sales floor. Paint to match wall surface (color TBV).

NOTES:
- UL Label to be placed on top of letters

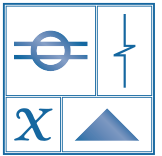

BLAIR SIGN
PROGRAMS

(619) 792-1600
www.blairsign.net
CA License #677503

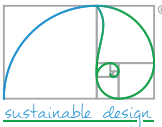

CLIENT:

Burlington

PROJECT:

Concord, NH #479
Design Study

ADDRESS:

50 Storrs Street
Concord, NH 03301

DATE:

01/02/2024

DESIGNER:

E. Cameron

REVISIONS:

REVISIONS:	BY:
1: 03/21/2024	EC
2: 09/20/2024	EC
3: 04/04/2025	EC
4: 05/13/2025	VZ
5: 06/10/2025	VZ
6: 06/13/2025	VZ
7: 06/30/2025	VZ
8: 07/11/2025	VZ

SIGN(S) TYPE: A
C.I. & TAG LINE DETAIL

SECTION III
SHEET 6

© 2024 BLAIR SIGN PROGRAMS

EXTERIOR BURLINGTON, BRANDS, DEALS.: WHITE, FACE-LIT, CHANNEL LETTERS, REMOTE P/S

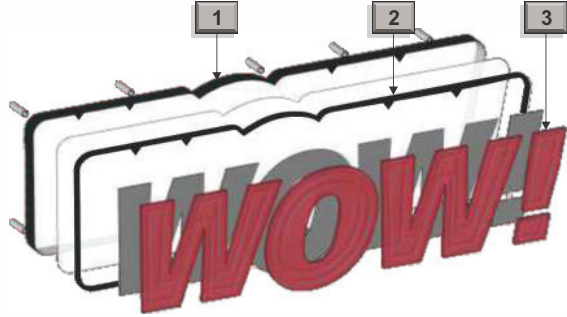

EXPLODED VIEW

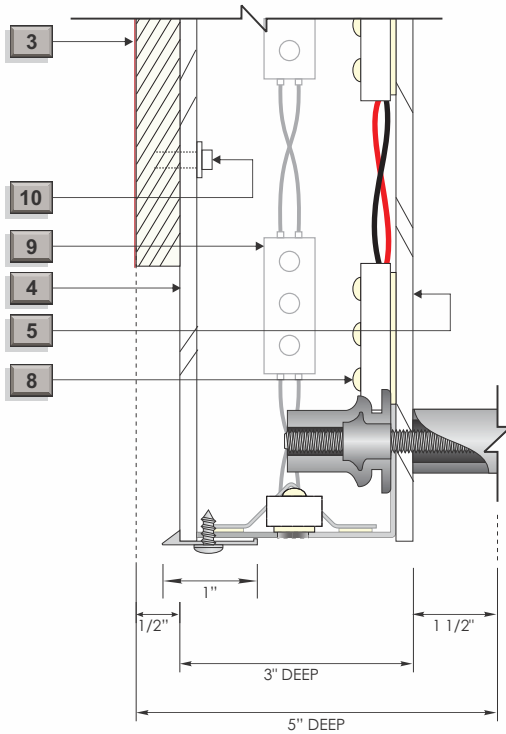

DETAIL A

WALL CONSTRUCTION:
NICHHA Architectural
wall panels fastened to
sheathing over 10" metal
studs over existing wall

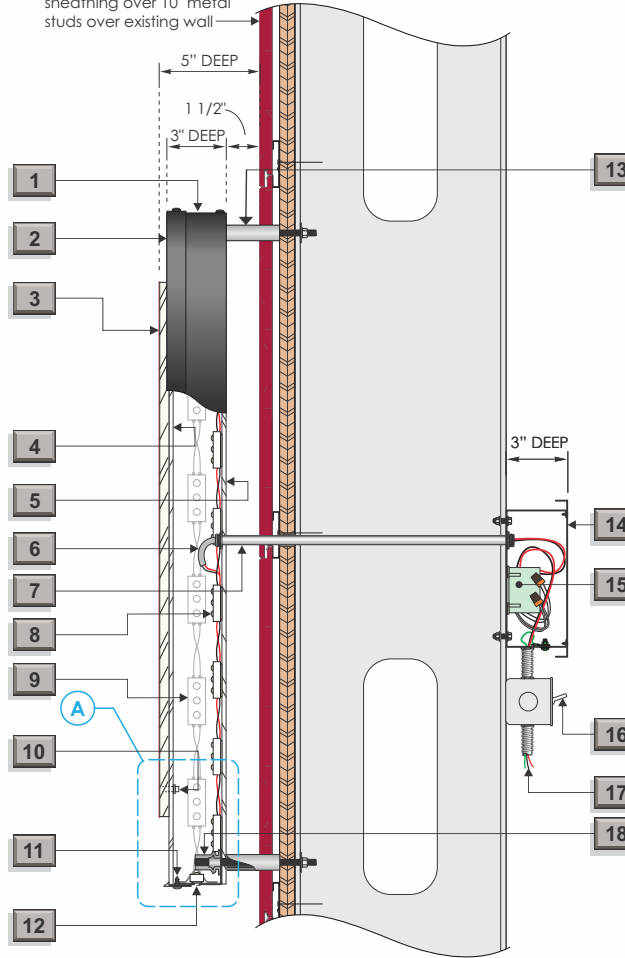

TYPICAL SECTION

EXTERIOR RED WOW!: FACE-LIT, HALO-LIT, LETTERS, REMOTE P/S

1	.090" aluminum returns. Interior metal surfaces to be white, reflective finish. Exterior metal surfaces painted matte black.
2	1" black trim-cap
3	1/2" clear acrylic /w frosted edges w/ translucent red vinyl (custom color, PMS 207c) applied 1st surface
4	3/16" White Lexan
5	3/16" clear Lexan backs, frosted
6	Exterior jacketed cable, UL listed (6' whip, each letter)
7	1/2" aluminum pass-through, UL listed
8	Prism white 6500k led modules (Sloan)
9	PosterBox white 6500k led modules (Sloan), mounted to interior side of returns.
10	1/8" Clear acrylic studs
11	Stainless steel, pan-head screw painted to match trim-cap.
12	1/4" weep-hole with angled light-shield baffle.
13	Tube spacers.
14	SNAP 2 Power supply box part no. 980054c, UL listed. Use fabricated alum. wire way when wires are in view of sales floor. Paint to match wall surface (color TBV).
15	Power supply, UL listed
16	Disconnect switch, UL listed
17	Incoming power, provided by others
18	Steel flange knurled rivet nut 1/4-20 with nuts, washers and 12" by 1/4" threaded rod, minimum 2 per letter.

NOTES:
- UL Label to be placed on top of letters

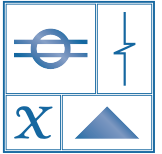

BLAIR SIGN
PROGRAMS

(619) 792-1600
www.blairsign.net
CA License #677503

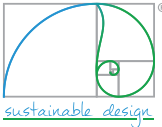

CLIENT:

Burlington

PROJECT:

Concord, NH #479
Design Study

ADDRESS:

50 Storrs Street
Concord, NH 03301

DATE:

01/02/2024

DESIGNER:

E. Cameron

REVISIONS:

REVISIONS:	BY:
1: 03/21/2024	EC
2: 09/20/2024	EC
3: 04/04/2025	EC
4: 05/13/2025	VZ
5: 06/10/2025	VZ
6: 06/13/2025	VZ
7: 06/30/2025	VZ
8: 07/11/2025	VZ

SIGN(S) TYPE: A
WOW! DETAIL

SECTION III
SHEET 7

© 2024 BLAIR SIGN PROGRAMS

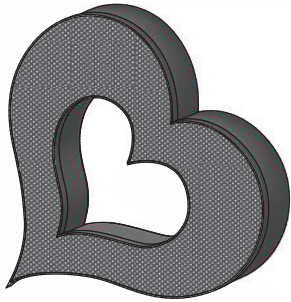

ASSEMBLED VIEW

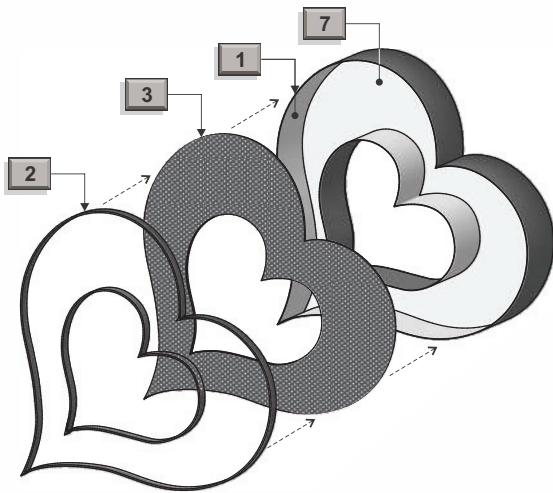

EXPLODED VIEW

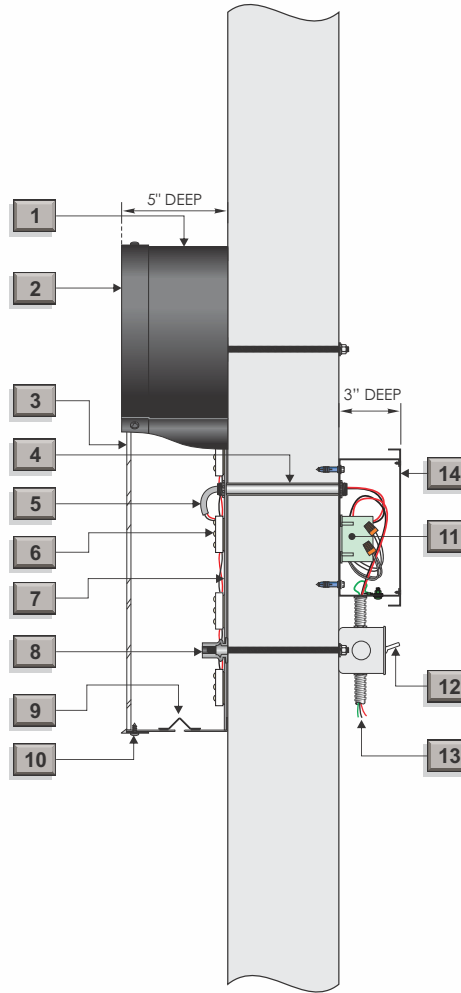

TYPICAL SECTION

EXTERIOR: RED, FACE-LIT, CHANNEL LETTERS, REMOTE P/S

1	.040" aluminum returns. Interior metal surfaces to be white, reflective finish. Exterior metal surfaces to be black, matte finish.
2	1" black trim-cap
3	3/16", clear acrylic with 3M 3635-222 perforated vinyl applied first surface and 3M 30% diffuser applied second surface.
4	1/2" aluminum pass-through, UL listed
5	Exterior jacketed cable, UL listed (6' whip, each Burlington letter)
6	White 6500k led modules (Sloan)
7	.040" aluminum back. Interior metal surfaces to be white, reflective finish. Exterior metal surfaces to be black, matte finish.
8	Steel flange knurled rivet nut 1/4-20 with nuts, washers and 12" by 1/4" threaded rod, minimum 2 per letter.
9	1/4" weep-hole with angled light-shield baffle
10	Stainless steel, pan-head screw painted to match trim-cap
11	Power supply with SNAP 2 P/S box, part no. 980054c, UL listed
12	Disconnect switch, UL listed
13	Incoming power, provided by others
14	SNAP 2 Power supply box shown. Use fabricated aluminum wire way when wires are in view of sales floor. Paint to match wall surface (color TBV).

NOTES:
- UL Label to be placed on top of letters

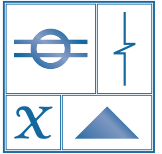

**BLAIR SIGN
PROGRAMS**

(619) 792-1600
www.blairsign.net
CA License #677503

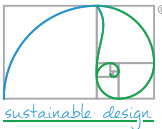

CLIENT:

Burlington

PROJECT:

Concord, NH #479
Design Study

ADDRESS:

50 Storrs Street
Concord, NH 03301

DATE:

01/02/2024

DESIGNER:

E. Cameron

REVISIONS:

REVISIONS:	BY:
1: 03/21/2024	EC
2: 09/20/2024	EC
3: 04/04/2025	EC
4: 05/13/2025	VZ
5: 06/10/2025	VZ
6: 06/13/2025	VZ
7: 06/30/2025	VZ
8: 07/11/2025	VZ

SIGN(S) TYPE: C

C. L. DETAIL

**SECTION III
SHEET 8**

© 2024 BLAIR SIGN PROGRAMS



ASSEMBLED VIEW

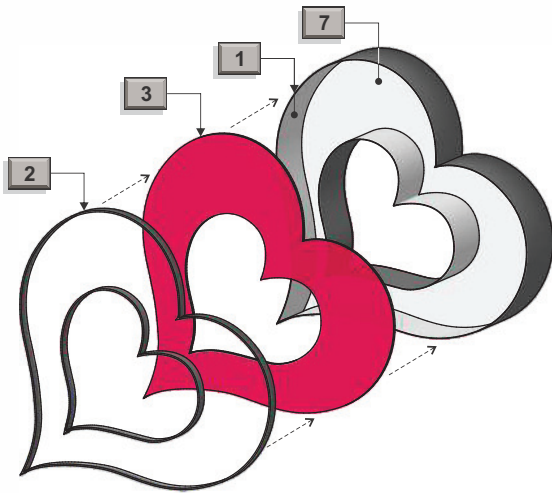

EXPLODED VIEW

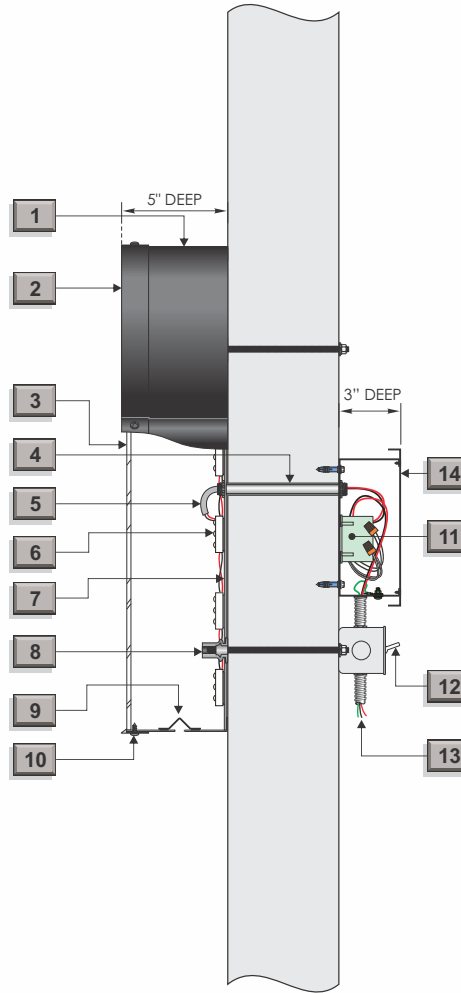

TYPICAL SECTION

EXTERIOR: RED, FACE-LIT, CHANNEL LETTERS, REMOTE P/S

1	.040" aluminum returns. Interior metal surfaces to be white, reflective finish. Exterior metal surfaces to be black, matte finish.
2	1" black trim-cap
3	3/16", translucent white Lexan with translucent red vinyl (custom color, PMS 207c) applied first surface.
4	1/2" aluminum pass-through, UL listed
5	Exterior jacketed cable, UL listed (6' whip, each Burlington letter)
6	Red led modules (Sloan / Prism)
7	.040" aluminum back. Interior metal surfaces to be white, reflective finish. Exterior metal surfaces to be black, matte finish.
8	Steel flange knurled rivet nut 1/4-20 with nuts, washers and 12" by 1/4" threaded rod, minimum 2 per letter.
9	1/4" weep-hole with angled light-shield baffle
10	Stainless steel, pan-head screw painted to match trim-cap
11	Power supply with SNAP 2 P/S box, part no. 980054c, UL listed
12	Disconnect switch, UL listed
13	Incoming power, provided by others
14	SNAP 2 Power supply box shown. Use fabricated aluminum wire way when wires are in view of sales floor. Paint to match wall surface (color TBV).

NOTES:
- UL Label to be placed on top of letters

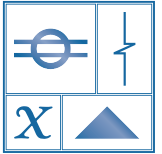

BLAIR SIGN
PROGRAMS

(619) 792-1600
www.blairsign.net
CA License #677503

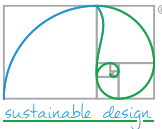

CLIENT:

Burlington

PROJECT:

Concord, NH #479
Design Study

ADDRESS:

50 Storrs Street
Concord, NH 03301

DATE:

01/02/2024

DESIGNER:

E. Cameron

REVISIONS:

REVISIONS:	BY:
1: 03/21/2024	EC
2: 09/20/2024	EC
3: 04/04/2025	EC
4: 05/13/2025	VZ
5: 06/10/2025	VZ
6: 06/13/2025	VZ
7: 06/30/2025	VZ
8: 07/11/2025	VZ

SIGN(S) TYPE: D
C. L. DETAIL

SECTION III
SHEET 9

© 2024 BLAIR SIGN PROGRAMS

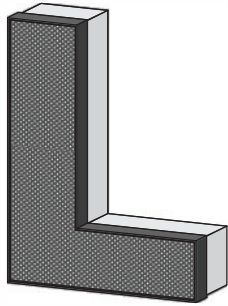

ASSEMBLED VIEW

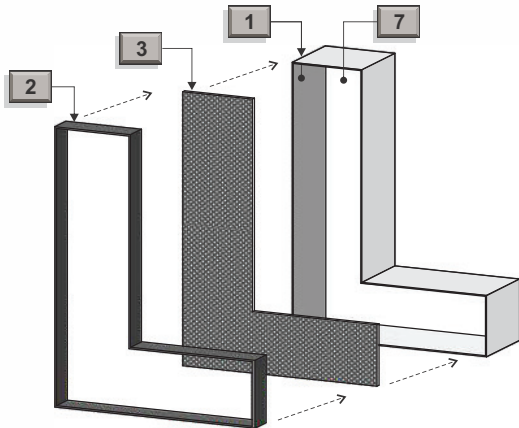

EXPLODED VIEW

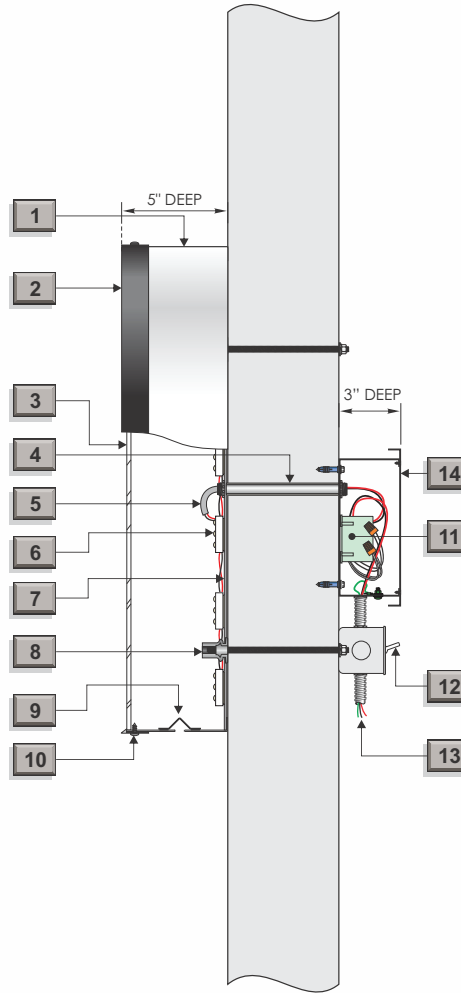

TYPICAL SECTION

1	.040" aluminum returns. Interior metal surfaces to be white, reflective finish. Exterior metal surfaces to be white, satin finish.
2	1" black trim-cap
3	3/16", clear acrylic with 3M 3635-222 perforated vinyl applied first surface and 3M 30% diffuser applied second surface.
4	1/2" aluminum pass-through, UL listed
5	Exterior jacketed cable, UL listed (6' whip, each Burlington letter)
6	White 6500k led modules (Sloan)
7	.040" aluminum back. Interior metal surfaces to be white, reflective finish. Exterior metal surfaces to be black, matte finish.
8	Steel flange knurled rivet nut 1/4-20 with nuts, washers and 12" by 1/4" threaded rod, minimum 2 per letter.
9	1/4" weep-hole with angled light-shield baffle
10	Stainless steel, pan-head screw painted to match trim-cap
11	Power supply with SNAP 2 P/S box, part no. 980054c, UL listed
12	Disconnect switch, UL listed
13	Incoming power, provided by others
14	SNAP 2 Power supply box shown. Use fabricated aluminum wire way when wires are in view of sales floor. Paint to match wall surface (color TBV).

NOTES:
- UL Label to be placed on top of letters

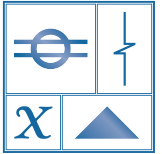

**BLAIR SIGN
PROGRAMS**

(619) 792-1600
www.blairsign.net
CA License #677503

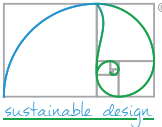

CLIENT:

Burlington

PROJECT:

Concord, NH #479
Design Study

ADDRESS:

50 Storrs Street
Concord, NH 03301

DATE:

01/02/2024

DESIGNER:

E. Cameron

REVISIONS:

REVISIONS:	BY:
1: 03/21/2024	EC
2: 09/20/2024	EC
3: 04/04/2025	EC
4: 05/13/2025	VZ
5: 06/10/2025	VZ
6: 06/13/2025	VZ
7: 06/30/2025	VZ
8: 07/11/2025	VZ

SIGN(s) TYPE: D
C.I. & TAG LINE DETAIL

SECTION III
SHEET 10

© 2024 BLAIR SIGN PROGRAMS

EXTERIOR: PERFORATED BLACK, FACE-LIT, CHANNEL LETTERS, REMOTE P/S

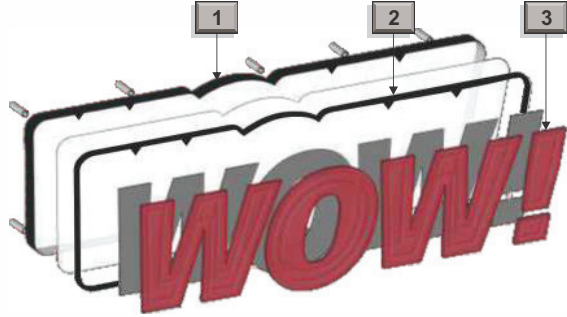

EXPLODED VIEW

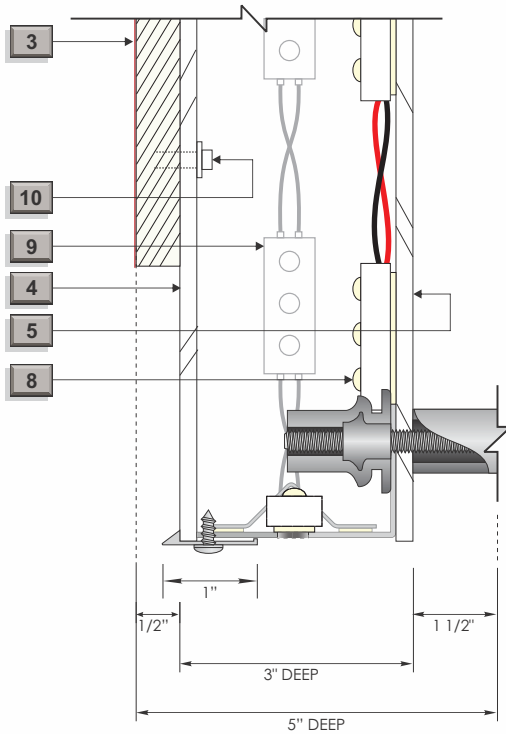

DETAIL A

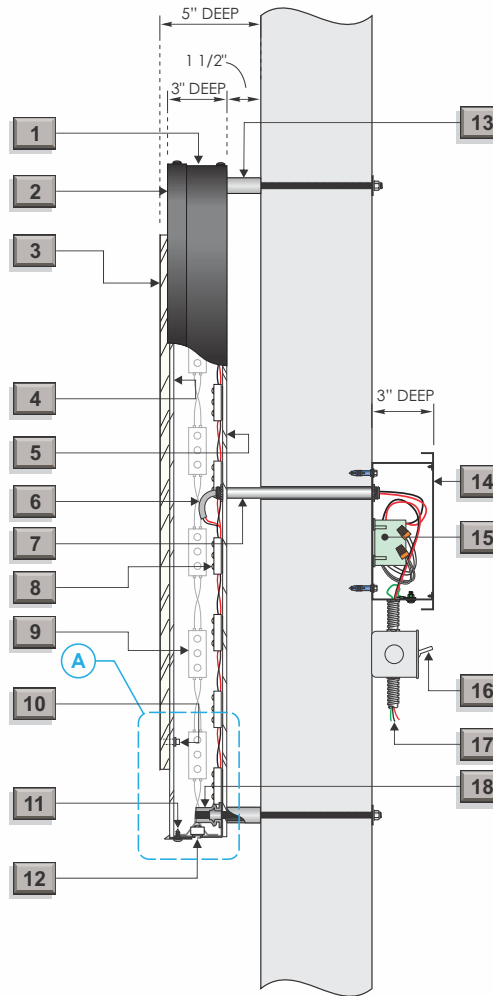

TYPICAL SECTION

EXTERIOR RED WOW!: FACE-LIT, HALO-LIT, LETTERS, REMOTE P/S

- 1 .090" aluminum returns. Interior metal surfaces to be white, reflective finish. Exterior metal surfaces painted matte black.
- 2 1" black trim-cap. (Above 36" use 3/4" Aluminum retainer painted black, matte finish.)
- 3 1/2" clear acrylic /w frosted edges w/ translucent red vinyl (custom color, PMS 207c) applied 1st surface
- 4 3/16" White Lexan
- 5 3/16" clear Lexan backs, frosted
- 6 Exterior jacketed cable, UL listed (6' whip, each letter)
- 7 1/2" aluminum pass-through, UL listed
- 8 Prism white 6500k led modules (Sloan)
- 9 PosterBox white 6500k led modules (Sloan), mounted to interior side of returns.
- 10 1/8" Clear acrylic studs
- 11 Stainless steel, pan-head screw painted to match trim-cap.
- 12 1/4" weep-hole with angled light-shield baffle.
- 13 Tube spacers.
- 14 SNAP 2 Power supply box part no. 980054c, UL listed. Use fabricated alum. wire way when wires are in view of sales floor. Paint to match wall surface (color TBV).
- 15 Power supply, UL listed
- 16 Disconnect switch, UL listed
- 17 Incoming power, provided by others
- 18 Steel flange knurled rivet nut 1/4-20 with nuts, washers and 12" by 1/4" threaded rod, minimum 2 per letter.

NOTES: UL Label to be placed on top of letters

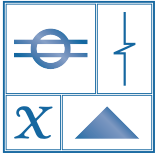

BLAIR SIGN
PROGRAMS

(619) 792-1600
www.blairsign.net
CA License #677503

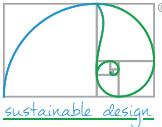

CLIENT:

Burlington

PROJECT:

Concord, NH #479
Design Study

ADDRESS:

50 Storrs Street
Concord, NH 03301

DATE:

01/02/2024

DESIGNER:

E. Cameron

REVISIONS:

REVISIONS:	BY:
1: 03/21/2024	EC
2: 09/20/2024	EC
3: 04/04/2025	EC
4: 05/13/2025	VZ
5: 06/10/2025	VZ
6: 06/13/2025	VZ
7: 06/30/2025	VZ
8: 07/11/2025	VZ

SIGN(S) TYPE: D
WOW! DETAIL

SECTION III
SHEET 11

© 2024 BLAIR SIGN PROGRAMS