



PLAN DETAILED REPORT PL-ADR-2025-0078 FOR CITY OF CONCORD

Plan Type: PLAN - Architectural Design Review **Project:** 2025-028 16 S Main St ADR **App Date:** 03/11/2025
Work Class: Architectural Design Review **District:** City of Concord, NH **Exp Date:** NOT AVAILABLE
Status: In Review **Square Feet:** 0.00 **Completed:** NOT COMPLETED
Valuation: \$0.00 **Assigned To:** Alec Bass **Approval**
Expire Date:

Description: Remove existing permitted sign faces on front and side of building and replace them with the same size and materials as the existing faces, adding the new Bank of NH Stage logos.

Parcel: 2239	Main	Address: 16 S Main St Concord, NH	Main	Zone: CBP(Central Business Performance Distri
---------------------	------	---	------	--

Owner Tiffany Baert Business: (603) 527-3270 Mobile: (603) 527-3270	Applicant/Agent NEOPCO Signs Glen Schadlick 5 Crosby St. Concord, NH 03301 Business: 6032288652	Owner Steven Martin 44 South Main Street, Concord, NH 03301 Concord, NH, NH 03301 Home: (603) 344-7007 Business: (603) 225-1111 Mobile: (603) 344-7007
---	---	--



City of Concord
 37 Green St
 Concord, NH 03301
 www.concordnh.gov

Permit

Permit NO. **SP-0494-2025**

Permit Type: **PLNG - Sign Or Awning**

Work Classification: **Sign**

Permit Status: **Fees Due**

Issue Date:

Expiration:

Location Address

Parcel Number

16 S Main St, Concord, NH

2239

Contacts

NEOPCO Signs 5 Crosby St., Concord, NH 03301 (603)228-8652	Applicant glen@neopcosigns.com
--	--

Description: BNH-Stage-Replace existing faces for internally illuminated Bank of NH Stage signs on front and side alley.

Valuation:	<u> \$0.00 </u>
Total Sq Feet:	<u> 0.00 </u>

Inspection Requests:

603-225-8580

Fees	Amount
CD - Application for Sign	\$30.00
CD - Sign application PB review	\$30.00
CD - Sign Permit Fee SF Cost	\$78.75
Total:	<u>\$138.75</u>

Payments	Amt Paid
Total Fees	
Amount Due:	

Available Inspections:	
Inspection Type	
Zoning Code Enforcement	0
CD - Final Sign	180

Applicant certifies that all the information given is correct and true and that all work performed will comply with applicable City of Concord and State of New Hampshire, Building and Fire Codes, Ordinances, Laws and Regulations.

Additional Information

Sign Dimensions: 35"x142"

Total Square Feet: 35

Is this Sign:: Replacement

Is this sign illuminated?: Yes

If Yes, pick one: Internal

Sign Projects over Public Right-of-Way: No

SignPermitAddtlInfo: CONDITIONS OF PERMIT • If a sign projects over a sidewalk or public way, it is mandatory for the owner to furnish a Certificate of Insurance in an amount not less than \$1,000,000, indemnifying the City of Concord against any form of liability. The policy shall provide for advance notification to the Code Administrator in the event of cancellation. If the policy should lapse or be canceled, the owner shall remove the sign immediately. • The Code Administrator or his authorized agent may revoke this permit at any time. • No portable signs shall be placed in the public right of way. • All signs shall conform to all requirements of the Zoning Ordinance for the district in which it is located. • All signs must be constructed of materials and methods conforming to the minimum standards of the City of Concord Building Code. • All signs which are illuminated or supplied with electric power must be UL listed and installed in accordance with the City of Concord Electrical Code and shall require separate electrical permits. • Sign permits are not transferrable in case of change of ownership, relocation, or alteration of size or structure.

Zoning District: CBP

Issued By: Brian Tremblay

Date



City of Concord
 37 Green St
 Concord, NH 03301
 www.concordnh.gov

Permit

Permit NO. **SP-0495-2025**

Permit Type: **PLNG - Sign Or Awning**

Work Classification: **Sign**

Permit Status: **Fees Due**

Issue Date:

Expiration:

Location Address

Parcel Number

16 S Main St, Concord, NH

2239

Contacts

NEOPCO Signs 5 Crosby St., Concord, NH 03301 (603)228-8652	Applicant glen@neopcosigns.com
--	--

Description: BNH Stage-South Elevation SIDE SIGN- Install replacement faces for existing permitted internally illuminated sign, using the same size and materials as the existing sign.

Valuation: \$0.00
Total Sq Feet: 0.00

Inspection Requests:

603-225-8580

Fees	Amount
CD - Sign application PB review	\$30.00
CD - Sign Permit Fee SF Cost	\$78.75
Total:	\$108.75

Payments	Amt Paid
Total Fees	
Amount Due:	

Available Inspections:

Inspection Type	
Zoning Code Enforcement	0
CD - Final Sign	180

Applicant certifies that all the information given is correct and true and that all work performed will comply with applicable City of Concord and State of New Hampshire, Building and Fire Codes, Ordinances, Laws and Regulations.

Additional Information

Sign Dimensions: 35"x142"

Total Square Feet: 35

Is this Sign:: Replacement

Is this sign illuminated?: Yes

If Yes, pick one: Internal

Sign Projects over Public Right-of-Way: No

SignPermitAddtlInfo: CONDITIONS OF PERMIT • If a sign projects over a sidewalk or public way, it is mandatory for the owner to furnish a Certificate of Insurance in an amount not less than \$1,000,000, indemnifying the City of Concord against any form of liability. The policy shall provide for advance notification to the Code Administrator in the event of cancellation. If the policy should lapse or be canceled, the owner shall remove the sign immediately. • The Code Administrator or his authorized agent may revoke this permit at any time. • No portable signs shall be placed in the public right of way. • All signs shall conform to all requirements of the Zoning Ordinance for the district in which it is located. • All signs must be constructed of materials and methods conforming to the minimum standards of the City of Concord Building Code. • All signs which are illuminated or supplied with electric power must be UL listed and installed in accordance with the City of Concord Electrical Code and shall require separate electrical permits. • Sign permits are not transferrable in case of change of ownership, relocation, or alteration of size or structure.

Zoning District: CBP

Issued By: Brian Tremblay

Date

BNH STAGE



LEGEND	A	B
MATERIAL/SIGN TYPE	Lexan Face with trans. vinyl	Lexan Face with trans. vinyl
SIZE	35"x142"	35"x142"
SINGLE SIDED- SF DOUBLE SIDED- DF	SF	SF
QUANTITY	1	1



Signs of Quality & Distinction

5 CROSBY STREET
CONCORD, NH 03301
(603) 228.8652
WWW.NEOPCO.COM

These plans are the exclusive property of NEOPCO Signs, and are the result of the original work of its employees. They are submitted to NEOPCO's client for the sole purpose of consideration of whether to purchase these plans or to purchase from NEOPCO a sign manufactured according to these plans.

Distribution or exhibition of these plans to anyone other than employees of said client, or use of these plans to construct a sign similar to the one embodied herein, is expressly forbidden. In the event that such exhibition or construction occurs, NEOPCO expects to be reimbursed \$1500 in compensation for time and effort entailed in creating these plans.

**ALL DESIGNS PRESENTED HERE ARE
© COPYRIGHTED DESIGNS**

BY INITIALING HERE, YOU ARE AUTHORIZING NEOPCO SIGNS TO PROCEED WITH PRODUCTION OF THE SIGNS HEREIN AND ALSO AUTHORIZING THE COLORS AND DESIGNS SHOWN AS WELL AS UNDERSTANDING THE COPYRIGHTED DESIGN RIGHTS OUTLINED ABOVE.

CLIENT'S INITIALS

PRESENTATION

CLIENT: BNH STAGE

DATE: 03/11/2025

SCALE: AS SHOWN

DRAWING NUMBER: 250311GS

SPECIAL NOTES:

**ACTUAL COLORS OF SIGNS
MAY BE SLIGHTLY DIFFERENT
THAN SHOWN ON SKETCH
DUE TO PRINT DIFFERENCES.**

© COPYRIGHTED DESIGNS

Concord GIS

Zoom In Zoom Out Full Extent Prev Extent Next Extent Pan Info Clear Graphics Refresh Help

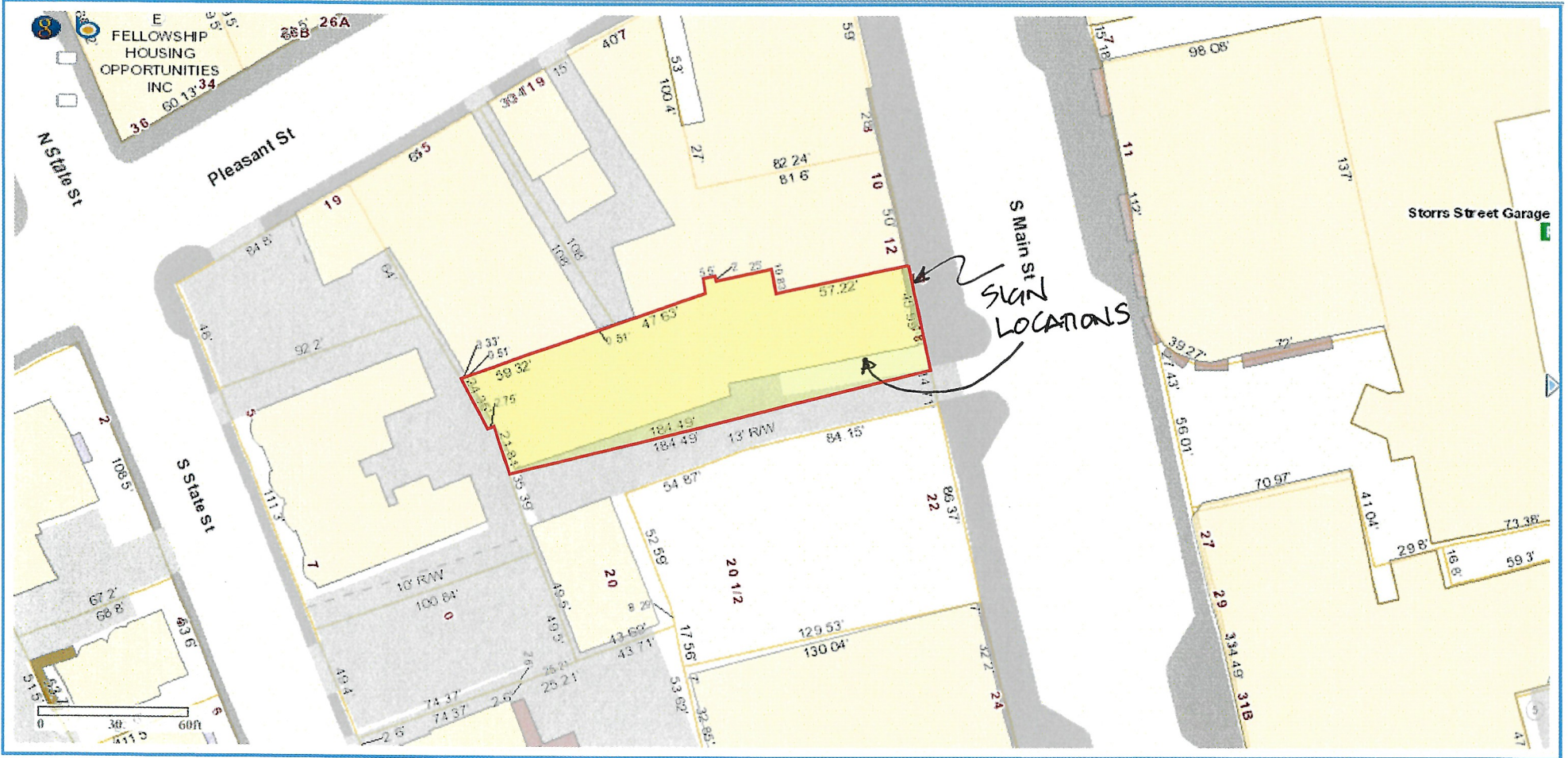

MAP BLOCK - 7412Z
 OWNER - CCA NORTH CORP
 FRONTAGE - 29' FRONT
 111+ SIDE
 ZONE - CBP