

ESTABLISHED 1949
NEOPCO SIGNS

Signs of Quality & Distinction
 5 CROSBY ST. CONCORD, NH 03301
 (603) 228.8652 WWW.NEOPCO.COM



PRESENTATION

CLIENT: COLDWELL BANKER

DATE: 2/18/2026

SCALE: AS SHOWN

DRAWING NUMBER: 260218GS

© COPYRIGHTED DESIGNS

CLIENT'S INITIALS

BY INITIALING HERE, YOU ARE AUTHORIZING NEOPCO SIGNS TO: (A) PROCEED WITH PRODUCTION OF THE SIGNS HEREIN, (B) AUTHORIZING THE COLORS & DESIGNS SHOWN, (C) ACKNOWLEDGING THE COPYRIGHTED DESIGN RIGHTS OUTLINED WITHIN.

DISCLAIMER

These plans are the exclusive property of NEOPCO Signs, and are the result of original work of its employees. Designs are submitted to NEOPCO Signs client for the sole purpose of consideration of whether to purchase these plans, or to purchase a sign from NEOPCO Signs, manufactured per this design. Distribution, exhibition or any use of these designs to anyone other than NEOPCO Signs, and it's employees, or use of these designs to construct a sign, logo or similar to the artwork embodied herein, is expressly forbidden. In the event that such exhibition, construction, or any design usage occurs, NEOPCO Signs expects to be reimbursed \$1,500.00 in compensation for time & effort in creating these plans/designs.

SPECIAL NOTES

ACTUAL COLORS OF SIGNS MAY BE SLIGHTLY DIFFERENT THAN SHOWN ON THIS SKETCH DUE TO PRINT DIFFERENCES. CLIENT IS RESPONSIBLE FOR CHECKING SPELLING.

© COPYRIGHTED DESIGNS

LEGEND

	SIZE	SINGLE SIDED-SF DOUBLE SIDED-DF	QUANTITY
A	36"x51"	SF	1
B	24"x51.5"	SF	1

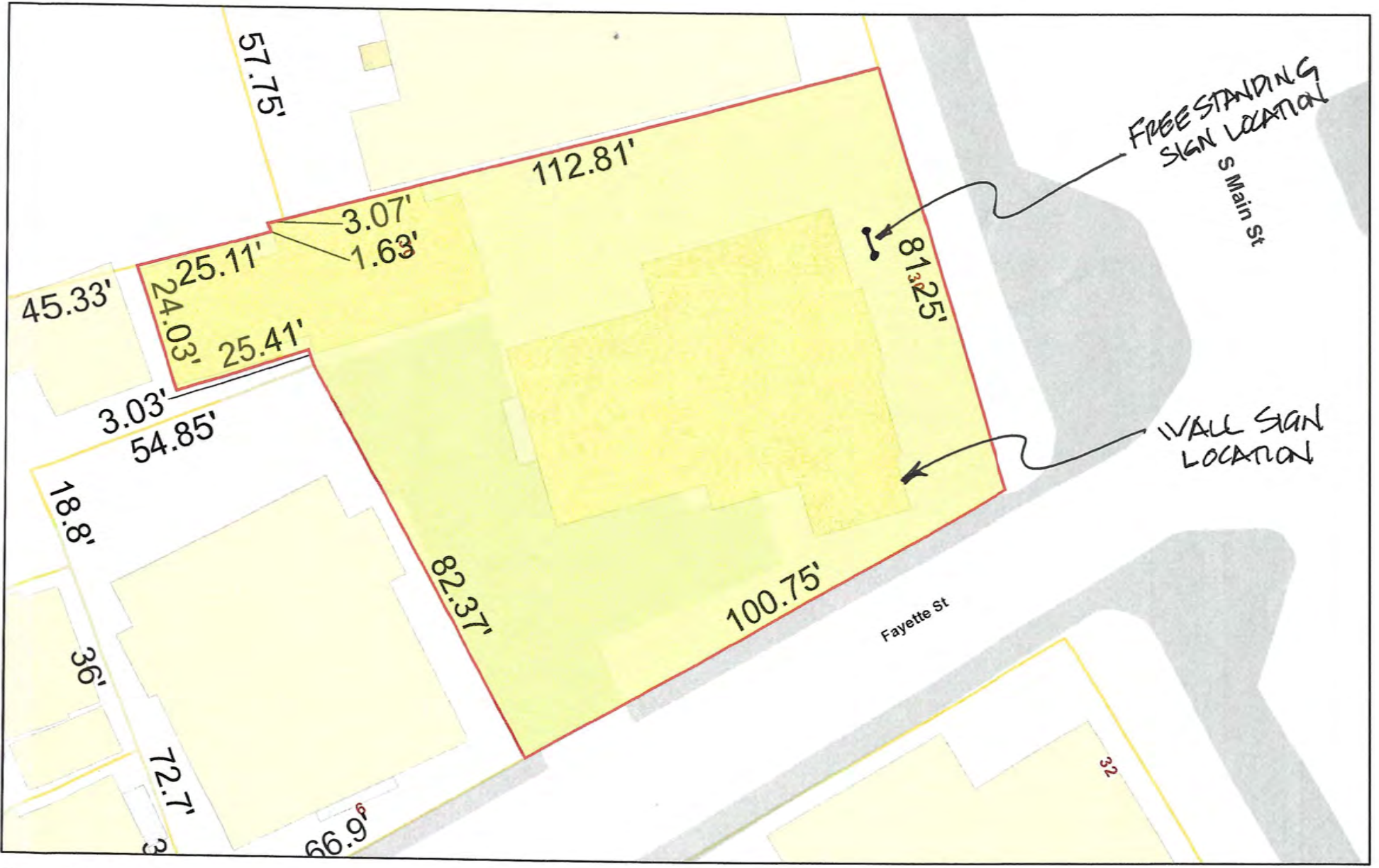

December 12, 2024

ZONE
CBP

MAP BLOCK 7412Z
 63 FT FRONTAGE
 81.25' LOT SIZE FRONT
 100.75' " " SIDE

