



PLAN DETAILED REPORT PL-ADR-2025-0092  
FOR CITY OF CONCORD

**Plan Type:** PLAN - Architectural Design Review

**Work Class:** Architectural Design Review

**Status:** In Review

**Valuation:** \$0.00

**Project:** 2025-051 45 Constitution Ave ADR

**District:** City of Concord, NH

**Square Feet:** 0.00

**Assigned To:** Alec Bass

**App Date:** 05/09/2025

**Exp Date:** NOT AVAILABLE

**Completed:** NOT COMPLETED

**Approval Expire Date:**

**Description:** Replace existing raceway channel letters with new set of raceway channel letters for new tenant.  
Replace non-illuminated lettering on existing brick monument with new non-illuminated lettering for new tenant

<b>Parcel:</b> 101181	Main	<b>Address:</b> 45 Constitution Ave Concord, NH	Main	<b>Zone:</b> OCP(Opportunity Corridor Performance C
-----------------------	------	--	------	---

Owner  
Christine Holman  
45 Constitution Ave.  
Concord, NH 03301  
Business: 6032242562  
Mobile: (603) 496-5701

Applicant/Agent  
Ed Batten  
893 Main Street  
Wakefield, MA, MA 01880  
Business: 7812454800

Invoice No.	Fee	Fee Amount	Amount Paid
NOT INVOICED	PD - Application Fee - \$150	\$150.00	\$0.00
Total for Invoice NOT INVOICED		\$150.00	\$0.00
Grand Total for Plan		\$150.00	\$0.00



**City of Concord**  
37 Green St  
Concord, NH 03301  
www.concordnh.gov

# Permit

Permit NO. **SP-0549-2025**

Permit Type: **PLNG - Sign Or Awning**

Work Classification: **Sign**

Permit Status: **Fees Paid**

Issue Date:

Expiration:

## Location Address

**45 Constitution Ave, Concord, NH**

## Parcel Number

**101181**

## Contacts

Ed Batten 893 Main Street, Wakefield, MA, MA 01880 (781)245-4800	<b>Applicant</b> edward@battensign.com
--	---

**Description:** Gallagher Wall Sign -Remove existing channel letters, furnish and install one set of raceway channel letters. Internally illuminated, 42" H x 264" W

<b>Valuation:</b>	<b>\$0.00</b>
<b>Total Sq Feet:</b>	<b>0.00</b>

## Inspection Requests:

603-225-8580

Fees	Amount
CD - Application for Sign	\$30.00
CD - Sign application PB review	\$30.00
CD - Sign Permit Fee SF Cost	\$173.81
<b>Total:</b>	<b>\$233.81</b>

Payments	Amt Paid
<b>Total Fees</b>	<b>\$233.81</b>
Credit Card	\$233.81
<b>Amount Due:</b>	<b>\$0.00</b>

## Available Inspections:

Inspection Type	
Zoning Code Enforcement	0
CD - Final Sign	180

Applicant certifies that all the information given is correct and true and that all work performed will comply with applicable City of Concord and State of New Hampshire, Building and Fire Codes, Ordinances, Laws and Regulations.

## Additional Information

**Sign Dimensions:** 42" H x 264" W

**Total Square Feet:** 77.25

**Is this Sign::** Replacement

**Is this sign illuminated?:** Yes

**If Yes, pick one:** Internal

**Sign Projects over Public Right-of-Way:** No

**How many feet over public right-of-way:** 0

**SignPermitAddtlInfo:** CONDITIONS OF PERMIT • If a sign projects over a sidewalk or public way, it is mandatory for the owner to furnish a Certificate of Insurance in an amount not less than \$1,000,000, indemnifying the City of Concord against any form of liability. The policy shall provide for advance notification to the Code Administrator in the event of cancellation. If the policy should lapse or be canceled, the owner shall remove the sign immediately. • The Code Administrator or his authorized agent may revoke this permit at any time. • No portable signs shall be placed in the public right of way. • All signs shall conform to all requirements of the Zoning Ordinance for the district in which it is located. • All signs must be constructed of materials and methods conforming to the minimum standards of the City of Concord Building Code. • All signs which are illuminated or supplied with electric power must be UL listed and installed in accordance with the City of Concord Electrical Code and shall require separate electrical permits. • Sign permits are not transferrable in case of change of ownership, relocation, or alteration of size or structure.

**Zoning District:** OCP

Issued By: Brian Tremblay

Date

CL.1 FACE LIT CHANNEL LETTERS - RACEWAY (QTY 1)

OVERALL SQUARE FOOTAGE: 77.3

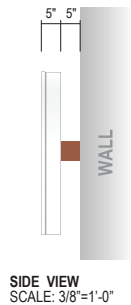
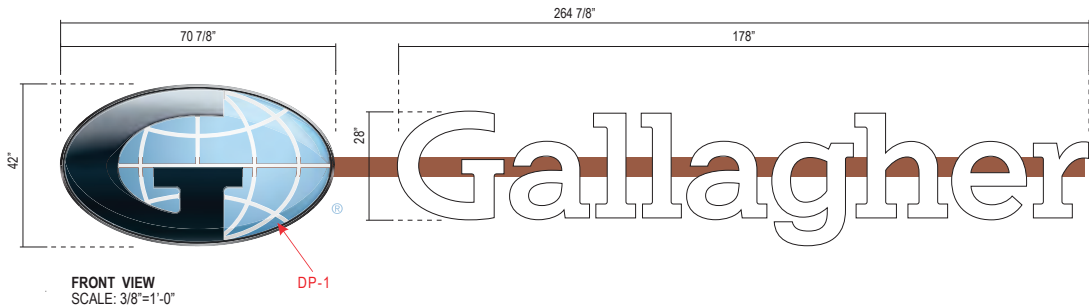

SPECIFICATIONS:

1. .040" X 5" PRE-FINISHED ALUMINUM COIL (WHITE INSIDE) (SEAMS IN CORNERS OR TOP)
2. ACM BACKS / LETTER LOCKED TO RETURNS
3. WHITE LED'S
4. 3/16" WHITE ACRYLIC / FIRST SURFACE APPLIED VINYL DP-1
5. 1" PRE-FINISHED JEWELITE CHEMICALLY BONDED TO FACES (SEAMS AT THE TOP)
6. #8 - 1/2" PAN HEAD SCREWS (NO MORE THAN 24" APART)
7. 1/4" DIA. WEEP HOLES W/ .063" DRAIN HOLE COVER (EXTERIOR APPLICATIONS ONLY)
8. 7/8" ELECTRICAL HOLE / 1/2" COUPLER WITH FLEXIBLE CONDUIT TO POWER SUPPLY BOX (IN MIDDLE OF LETTER UNLESS NOTED OTHERWISE)
9. 5" H x 4 3/4" D ALUMINUM RACEWAY EXTRUSION W/ REMOVABLE TOP COVER W/ 1/4" DIA. WEEP HOLES (EXTERIOR APPLICATIONS ONLY)
10. LED POWER SUPPLY ON 1/2" STANDOFF FROM BOTTOM OF RACEWAY
11. TOGGLE SWITCH MOUNTED TO RACEWAY / MOUNT TO TOGGLE FRONT TO BACK
12. FLEXIBLE CONDUIT W/ WEATHER TIGHT FLEX CONNECTOR (15 FT. MIN. LENGTH)
13. 1/4" THICK MOUNTING STRAPS
14. MOUNTING HARDWARE TO SUIT FIELD CONDITIONS
15. #10 X 1/2" LONG TEK SCREWS
16. #8 X 1/2" LONG SELF TAPPING SCREWS
17. RIGID CONDUIT THROUGH WALL WITH 1/2" - 1" STUB BEYOND INSIDE WALL, INSTALLER TO FOLLOW LOCAL CODE.
18. "C" CHANNEL OR EQUAL BRACING AS REQUIRED
19. WHITE ALUMINUM DISC w/ FIRST SURFACE APPLIED DIGITALLY PRINTED @ ATTACHED TO WALL w/ SILICONE DP-4

NOTES:

1. ETL STICKER TO BE PLACED ON BOTTOM OF SIGN, VISIBLE FROM GROUND

COLORS / FINISHES:

- LOGO  
DP-1 CONCEPT 224-60 TRANSLUCENT  
CUSTOM PRINT GLOBE LOGO
- TRIM CAP  
P-4 MP WHITE
- RETURNS  
P-4 MP WHITE
- RACEWAY  
P-5 SW 2803 ROCKWOOD TERRA COTTA
- REGISTRATION MARK  
DP-4 TO MATCH PMS 543C LIGHT BLUE

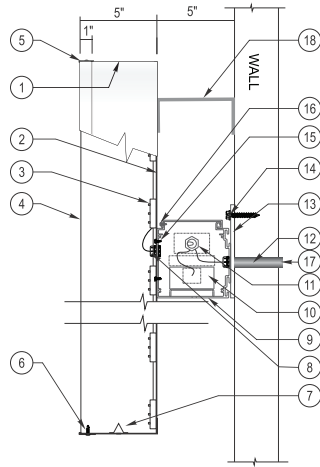

**JONES SIGN**  
Your Vision. Accomplished.  
A MORTENSEN COMPANY

JOB # **301821\_R0**  
DATE: 01.21.2025  
DESIGNER: J. SOTKA  
SALES REP: C. PRICE  
PROJ MGR: D. KELLY

REQUIRED:

- ☐ FIELD SURVEY ☐ PAINT COLOR ☐ FONTS  
☐ VECTOR ARTWORK ☐ CLIENT PMS COLOR ☐ ENGINEERING

OTHER:

LANDLORD APPROVAL

DATE

CLIENT APPROVAL

DATE

**Gallagher**

GALLAGHER  
45 CONSTITUTIONA AVE  
CONCORD, NH 03301

SHEET NUMBER

**4.0**

NORTH ELEVATION

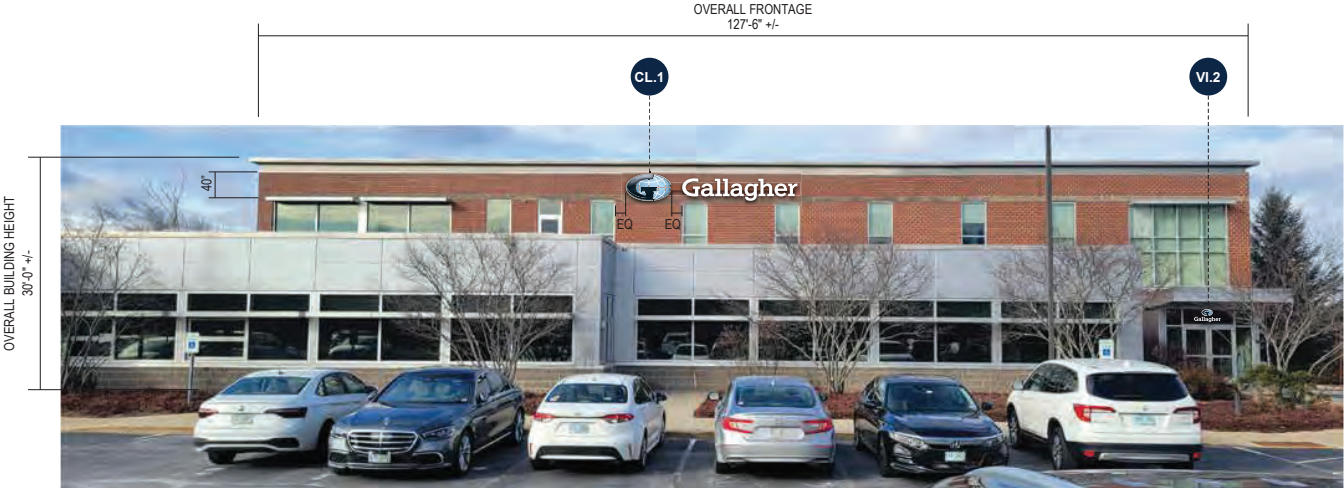

FRTON ELEVATION - PROPOSED SIGNAGE  
SCALE: 1/16" = 1'-0"

NOTE: PROPOSED REPRESENTATION IS NOT TO SCALE AND PROPORTIONS MAY VARY FROM ACTUAL SIZING



EXISTING CONDITIONS  
SCALE: NTS

<div><div>JONES SIGN</div><div>Your Vision. Accomplished.</div><div>A MORTENSEN COMPANY</div></div>	<div>JOB # 301821_R0</div> <div>DATE: 01.21.2025</div> <div>DESIGNER: J. SOTKA</div> <div>SALES REP: C. PRICE</div> <div>PROJ MGR: D. KELLY</div>	<div>REQUIRED:</div> <div><div><input type="checkbox"/> FIELD SURVEY</div><div><input type="checkbox"/> VECTOR ARTWORK</div><div><input type="checkbox"/> PAINT COLOR</div><div><input type="checkbox"/> CLIENT PMS COLOR</div><div><input type="checkbox"/> FONTS</div><div><input type="checkbox"/> ENGINEERING</div></div> <div>OTHER:</div>	<div>LANDLORD APPROVAL</div> <div>DATE</div>	<div><div><div>G</div></div><div>Gallagher</div></div>	<div>GALLAGHER</div> <div>45 CONSTITUTIONA AVE</div> <div>CONCORD, NH 03301</div>	<div>SHEET NUMBER</div> <div>3.0</div>
			<div>CLIENT APPROVAL</div> <div>DATE</div>			

This is an original, unpublished drawing by Jones Sign Co., Inc. It is for your personal use in conjunction with a project being planned for you by JONES SIGN. It is not to be shown to anyone outside of your organization, nor is it to be used, reproduced, copied or exhibited in any fashion. Use of this design or the salient elements of this design in any sign done by any other company, without the express written permission of JONES SIGN, is forbidden by law and carries a civil forfeiture of up to 25% of the purchase price of the sign. JONES SIGN will endeavor to closely match colors, including PMS, where specified. We cannot guarantee exact matches due to varying compatibility of surface materials and paints used. All sizes and dimensions are illustrated for client's conception of project and are not to be understood as being exact size or exact scale.











**City of Concord**  
37 Green St  
Concord, NH 03301  
www.concordnh.gov

# Permit

Permit NO. **SP-0550-2025**

Permit Type: **PLNG - Sign Or Awning**

Work Classification: **Sign**

Permit Status: **Fees Paid**

Issue Date:

Expiration:

## Location Address

**45 Constitution Ave, Concord, NH**

## Parcel Number

**101181**

## Contacts

Ed Batten

893 Main Street, Wakefield, MA, MA 01880

(781)245-4800

### Applicant

edward@battensign.com

**Description:** Gallagher-Remove acrylic letters from existing brick monument. Install new acrylic letters in same location. Single sided. 22" H x 5'-7" W

**Valuation:** \$0.00

**Total Sq Feet:** 0.00

## Inspection Requests:

603-225-8580

Fees	Amount
CD - Application for Sign	\$30.00
CD - Sign application PB review	\$30.00
CD - Sign Permit Fee SF Cost	\$23.18
<b>Total:</b>	<b>\$83.18</b>

Payments	Amt Paid
<b>Total Fees</b>	<b>\$83.18</b>
Credit Card	\$83.18
<b>Amount Due:</b>	<b>\$0.00</b>

## Available Inspections:

Inspection Type	
Zoning Code Enforcement	0
CD - Final Sign	180

Applicant certifies that all the information given is correct and true and that all work performed will comply with applicable City of Concord and State of New Hampshire, Building and Fire Codes, Ordinances, Laws and Regulations.

## Additional Information

**Sign Dimensions:** 22" H x 5'-7" W

**Total Square Feet:** 10.3

**Is this Sign::** Replacement

**Is this sign illuminated?:** No

**If Yes, pick one:** N/A

**Sign Projects over Public Right-of-Way:** No

**How many feet over public right-of-way:** 0

**SignPermitAddtlInfo:** CONDITIONS OF PERMIT • If a sign projects over a sidewalk or public way, it is mandatory for the owner to furnish a Certificate of Insurance in an amount not less than \$1,000,000, indemnifying the City of Concord against any form of liability. The policy shall provide for advance notification to the Code Administrator in the event of cancellation. If the policy should lapse or be canceled, the owner shall remove the sign immediately. • The Code Administrator or his authorized agent may revoke this permit at any time. • No portable signs shall be placed in the public right of way. • All signs shall conform to all requirements of the Zoning Ordinance for the district in which it is located. • All signs must be constructed of materials and methods conforming to the minimum standards of the City of Concord Building Code. • All signs which are illuminated or supplied with electric power must be UL listed and installed in accordance with the City of Concord Electrical Code and shall require separate electrical permits. • Sign permits are not transferrable in case of change of ownership, relocation, or alteration of size or structure.

**Zoning District:** OCP

Issued By: Brian Tremblay

Date



MS.1 FLAT CUT OUT ACRYLIC LETTERS FOR EXISTING S/F MONUMENT SIGN - (QTY 1)

OVERALL SQUARE FOOTAGE: 12.26

NOTE: RE-USE FROM PEARLAND, TX

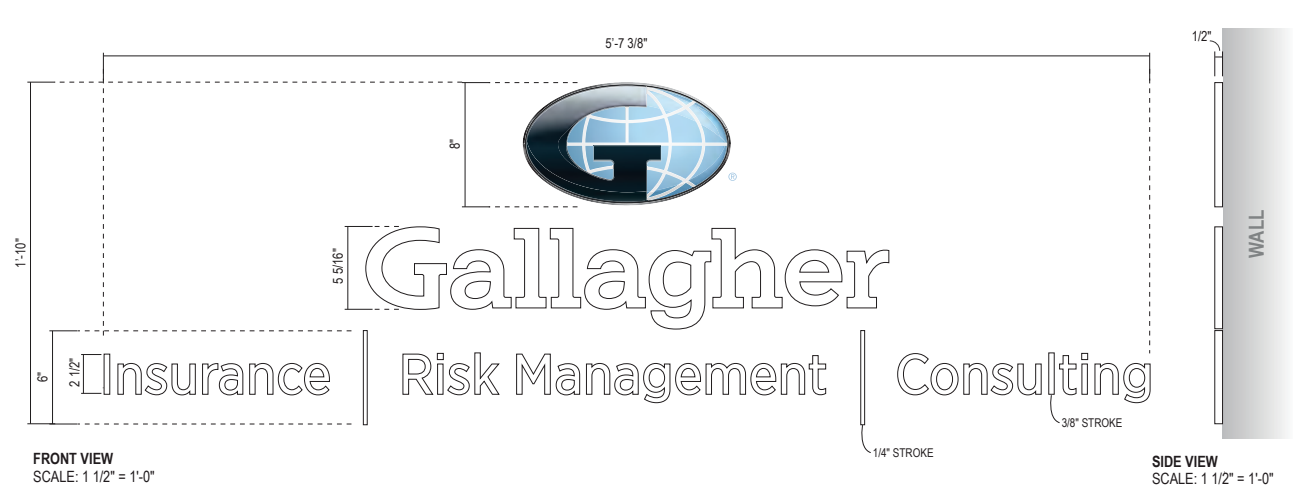

NOTE: TAGLINE STROKE HAS BEEN ADJUSTED TO ACCOMADATE FOR MOUNTING



PROPOSED VIEW  
SCALE: NTS

NOTE: PROPOSED REPRESENTATINS IS NOT TO SCALE AND PROPORTIONS MAY VARY FROM ACTUAL SIZING

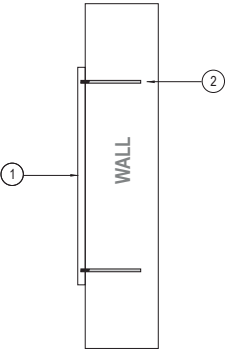

CROSS SECTION VIEW  
SCALE: X = 1'-0"

SPECIFICATIONS:	COLORS / FINISHES:
1. 1/2" FLAT CUT OUT ACRYLIC LETTERS FLUSH MOUNTED TO BRICK / PAINTED P-4 w/ FIRST SURFACE APPLIED VINYL LOGO OVERLAY DP-1	DP-1 3M LJ180CV3 OPAQUE CUSTOM PRINT GLOBE LOGO
2. STEEL STUDS DRILLED AND TAPPED	P-4 MP WHITE
NOTES: 1. SILICONE FILL ALL PENETRATIONS	

<b>JONES SIGN</b> Your Vision. Accomplished. <small>A MORTENSEN COMPANY</small>	JOB # <b>301821_R0</b> DATE: 01.21.2025 DESIGNER: J. SOTKA SALES REP: C. PRICE PROJ MGR: D. KELLY	<b>REQUIRED:</b> <input type="checkbox"/> FIELD SURVEY <input type="checkbox"/> PAINT COLOR <input type="checkbox"/> FONTS <input type="checkbox"/> VECTOR ARTWORK <input type="checkbox"/> CLIENT PMS COLOR <input type="checkbox"/> ENGINEERING <b>OTHER:</b>	LANDLORD APPROVAL	DATE		GALLAGHER 45 CONSTITUTIONA AVE CONCORD, NH 03301	SHEET NUMBER <b>5.0</b>
			CLIENT APPROVAL	DATE			

This is an original, unpublished drawing by Jones Sign Co., Inc. It is for your personal use in conjunction with a project being planned for you by JONES SIGN. It is not to be shown to anyone outside of your organization, nor is it to be used, reproduced, copied or exhibited in any fashion. Use of this design or the salient elements of this design in any sign done by any other company, without the express written permission of JONES SIGN, is forbidden by law and carries a civil forfeiture of up to 25% of the purchase price of the sign. JONES SIGN will endeavor to closely match colors, including PMS, where specified. We cannot guarantee exact matches due to varying compatibility of surface materials and paints used. All sizes and dimensions are illustrated for client's conception of project and are not to be understood as being exact size or exact scale.



45

THE **ROWLEY AGENCY** INC.

INSURANCE • BONDS • BENEFITS

PrimeMLS 







