

REVISION HISTORY

ISSUED FOR

PERMITTING

ALL DOCUMENTS PREPARED BY WILCOX & BARTON, INC. ARE INSTRUMENTS OF SERVICE IN RESPECT OF THE PROJECT. THEY ARE NOT INTENDED OR REPRESENTED TO BE SUITABLE FOR REUSE BY OWNER OR OTHERS. ANY REUSE WITHOUT WRITTEN VERIFICATION OR ADAPTATION BY WILCOX & BARTON, INC. FOR THE SPECIFIC PURPOSE INTENDED WILL BE AT OWNER'S SOLE RISK AND WITHOUT LIABILITY OR LEGAL EXPOSURE TO WILCOX & BARTON, INC. OWNER SHALL INDEMNIFY AND HOLD HARMLESS WILCOX & BARTON, INC. FROM ALL CLAIMS, DAMAGES, LOSSES AND EXPENSES ARISING OUT OF OR RESULTING THEREFROM.

OWNER

ST. PAUL'S SCHOOL
325 PLEASANT STREET
CONCORD, NH 03301

SITE

ST. PAUL'S SCHOOL
325 PLEASANT STREET
CONCORD, NH 03301
TAX MAP 723Z, LOT 13-1

PROPOSED DUNBARTON ROAD GATE PLAN

SCALE	DATE		
1"=10'	05/27/2026		
DRAFTED BY	CHECKED BY	PROJECT MGR	PROJECT NO.
KAD	KNH	ERL	STPA0004

STATE OF NEW HAMPSHIRE
ERIN R. LAMBERT
No. 11057
LICENSED PROFESSIONAL ENGINEER
ENGINEER ERIN R. LAMBERT
NH P.E. #11057

C1

01 OF 02

PL-ADM-2026-0144 administratively approved for the noted security gate installations on June 2, 2026 with the following conditions:

- All easement rights for public access by emergency vehicles, pedestrians, and bicyclists as outlined in the 2010 agreement between the City & St. Pauls School (MCRD Book 3180, Page 944) shall remain in force.
- The gates shall be required to include Opticom receivers to be installed to automatically open the gates upon approach by emergency vehicles using the following specifications as required by the Fire Marshal:
 - Gate opening controller shall be capable of responding to the Fire and Police Department's vehicle mounted, GTT or TOMAR brand, high priority, infrared traffic signal preemption emitters.

Timothy J. Thompson, AICP - Acting Clerk of the Planning Board/City Planner

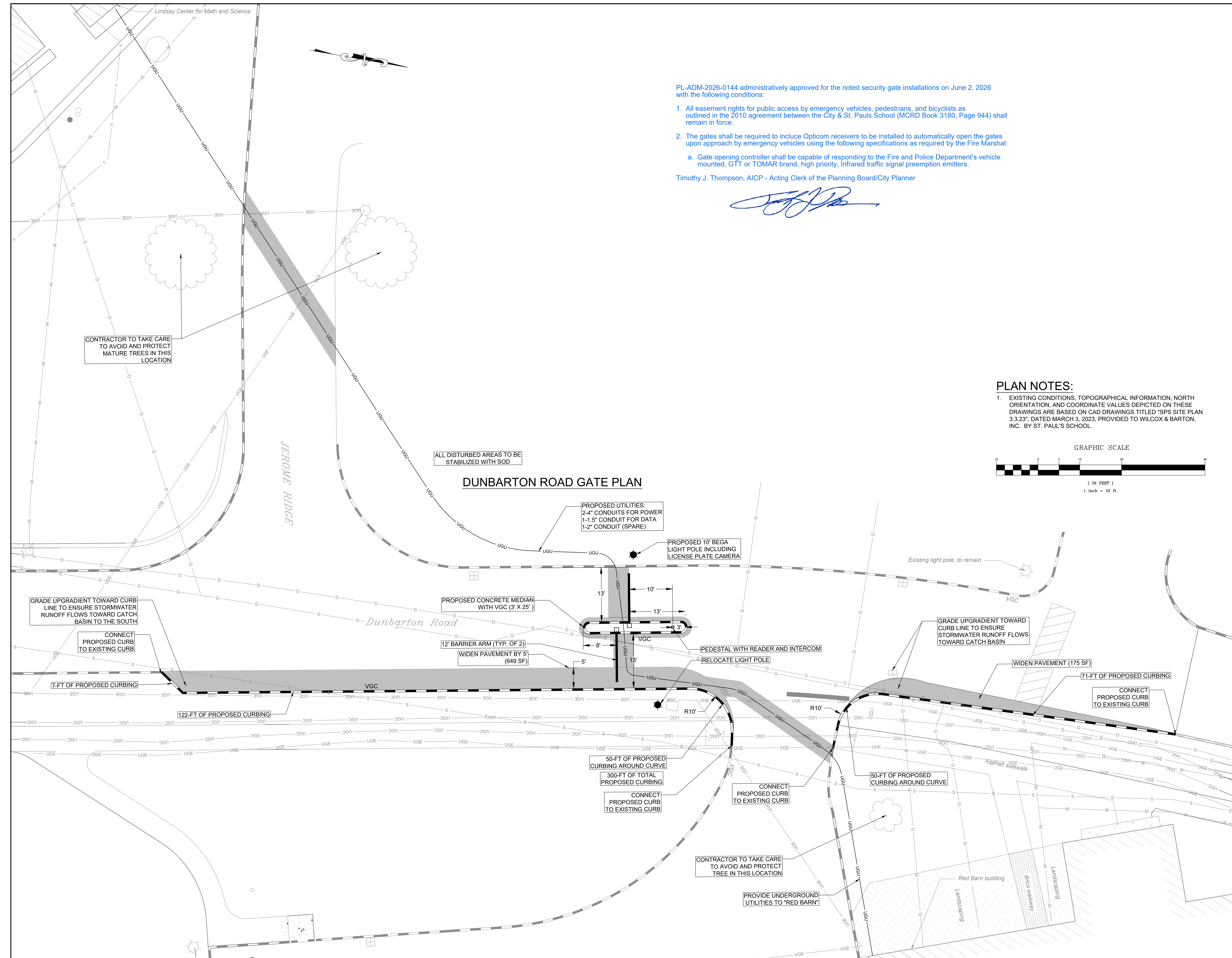

PLAN NOTES:

- EXISTING CONDITIONS, TOPOGRAPHICAL INFORMATION, NORTH ORIENTATION, AND COORDINATE VALUES DEPICTED ON THESE DRAWINGS ARE BASED ON CAD DRAWINGS TITLED "SPS SITE PLAN 3.3.23", DATED MARCH 3, 2023, PROVIDED TO WILCOX & BARTON, INC. BY ST. PAUL'S SCHOOL.

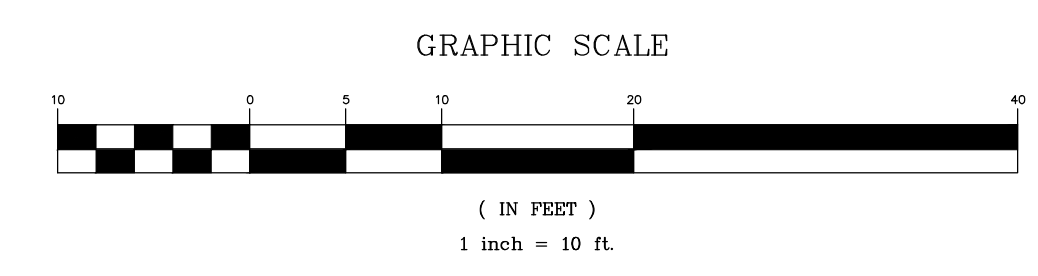

DUNBARTON ROAD GATE PLAN

ALL DISTURBED AREAS TO BE STABILIZED WITH SOD

PROPOSED UTILITIES:
2-4" CONDUITS FOR POWER
1-1.5" CONDUIT FOR DATA
1-2" CONDUIT (SPARE)

PROPOSED 10' BEGA LIGHT POLE INCLUDING LICENSE PLATE CAMERA

PROPOSED CONCRETE MEDIAN WITH VGC (3' X 25')

12' BARRIER ARM (TYP. OF 2)

WIDEN PAVEMENT BY 5' (649 SF)

PEDESTAL WITH READER AND INTERCOM

RELOCATE LIGHT POLE

GRADE UPGRADIENT TOWARD CURB LINE TO ENSURE STORMWATER RUNOFF FLOWS TOWARD CATCH BASIN

WIDEN PAVEMENT (175 SF)

71'-FT OF PROPOSED CURBING

CONNECT PROPOSED CURB TO EXISTING CURB

50'-FT OF PROPOSED CURBING AROUND CURVE

300'-FT OF TOTAL PROPOSED CURBING

CONNECT PROPOSED CURB TO EXISTING CURB

50'-FT OF PROPOSED CURBING AROUND CURVE

CONTRACTOR TO TAKE CARE TO AVOID AND PROTECT TREE IN THIS LOCATION

PROVIDE UNDERGROUND UTILITIES TO 'RED BARN'

CONTRACTOR TO TAKE CARE TO AVOID AND PROTECT MATURE TREES IN THIS LOCATION

GRADE UPGRADIENT TOWARD CURB LINE TO ENSURE STORMWATER RUNOFF FLOWS TOWARD CATCH BASIN TO THE SOUTH

CONNECT PROPOSED CURB TO EXISTING CURB

7'-FT OF PROPOSED CURBING

122'-FT OF PROPOSED CURBING

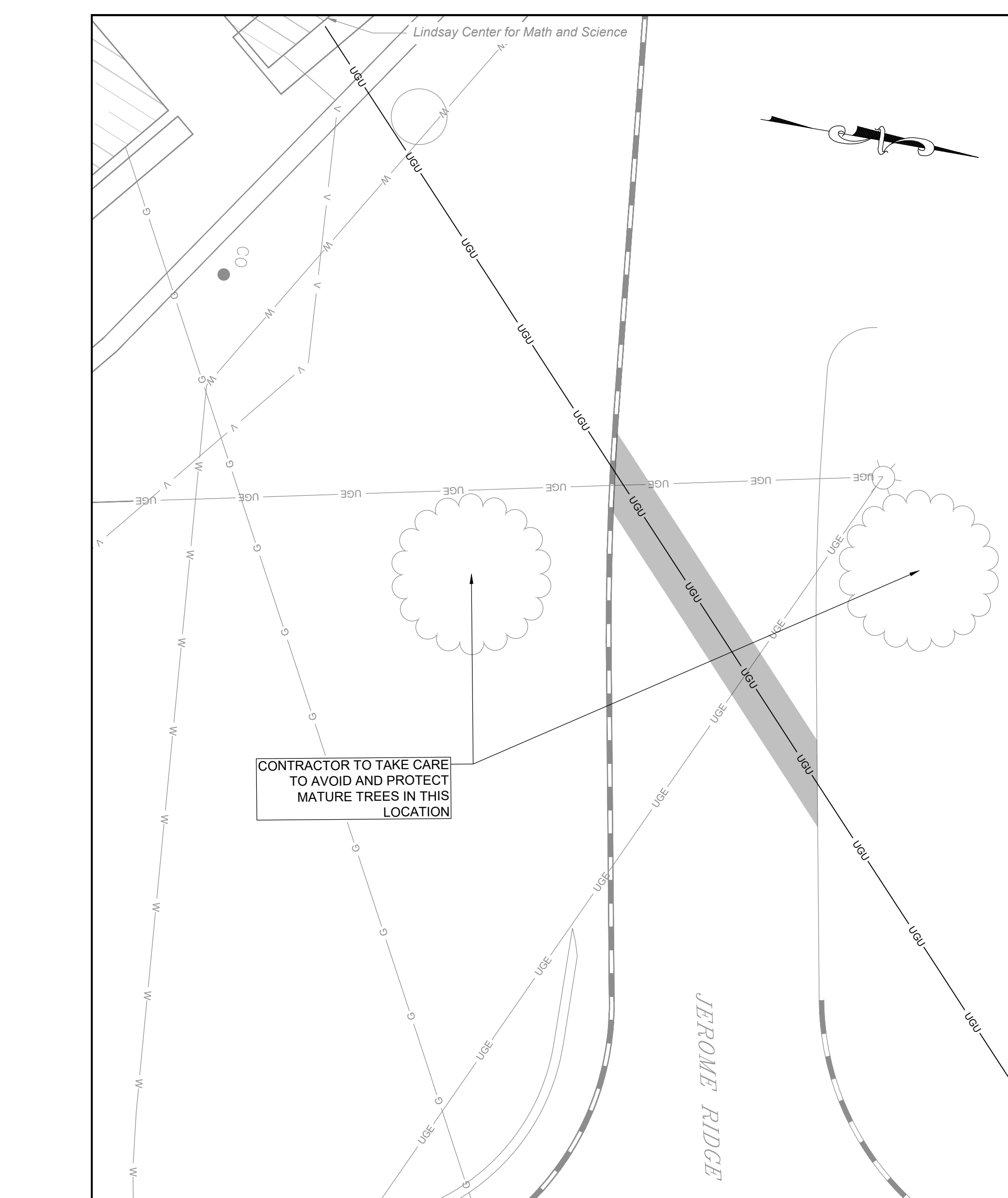

RECTORY ROAD GATE PLAN

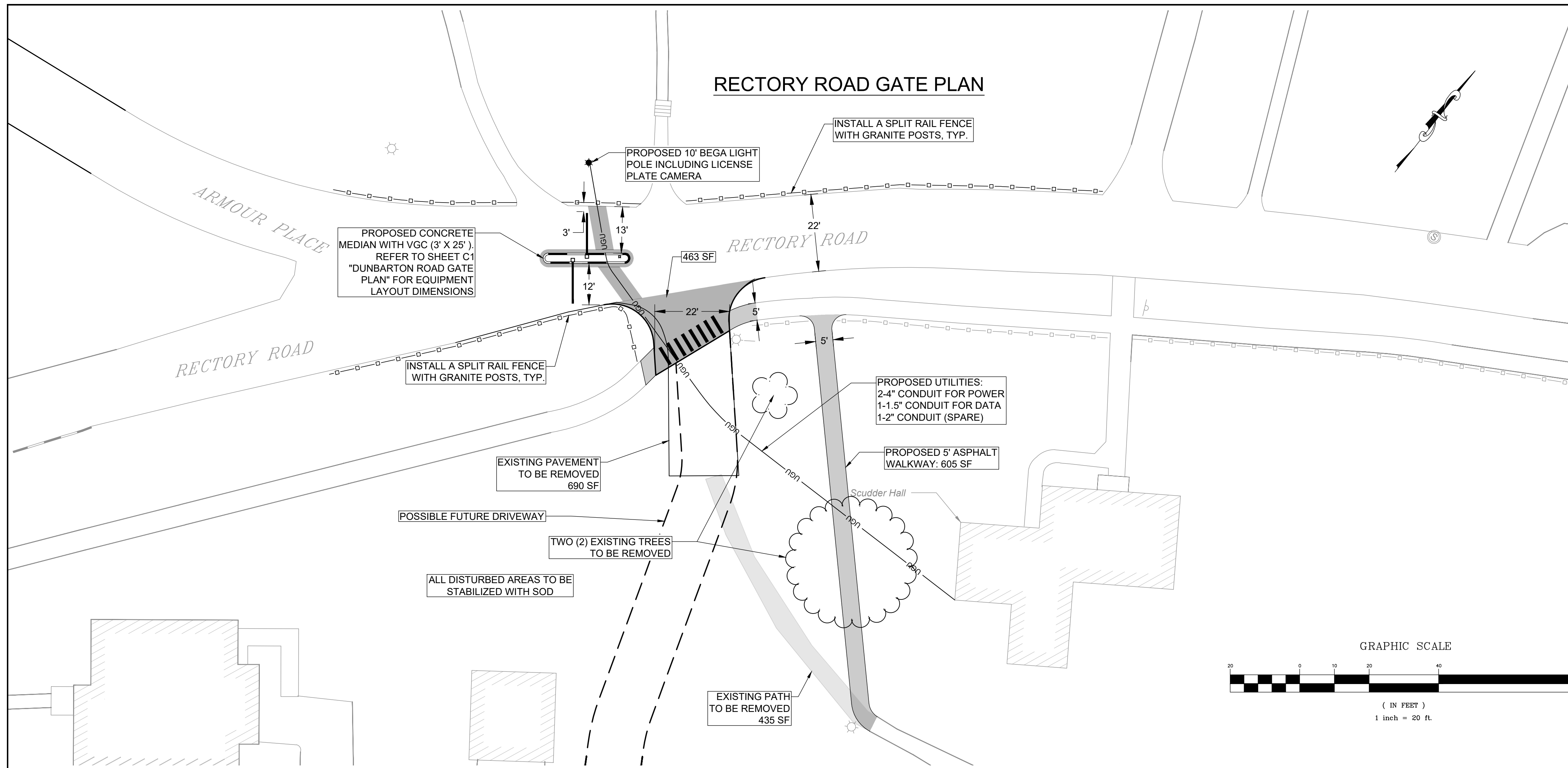

PLAN NOTES:

- EXISTING CONDITIONS, TOPOGRAPHICAL INFORMATION, NORTH ORIENTATION, AND COORDINATE VALUES DEPICTED ON THESE DRAWINGS ARE BASED ON CAD DRAWINGS TITLED "SPS SITE PLAN 3.3.23", DATED MARCH 3, 2023, PROVIDED TO WILCOX & BARTON, INC. BY ST. PAUL'S SCHOOL.

Wilcox & Barton INC.

CIVIL • ENVIRONMENTAL • GEOTECHNICAL

2 HOME AVENUE
CONCORD, NH 03301
603-369-4190
www.wilcoxandbarton.com

REVISION HISTORY

1.

ISSUED FOR

PERMITTING

ALL DOCUMENTS PREPARED BY WILCOX & BARTON, INC. ARE INSTRUMENTS OF SERVICE IN RESPECT OF THE PROJECT. THEY ARE NOT INTENDED OR REPRESENTED TO BE SUITABLE FOR REUSE BY OWNER OR OTHERS. ANY REUSE WITHOUT WRITTEN VERIFICATION OR ADAPTATION BY WILCOX & BARTON, INC. FOR THE SPECIFIC PURPOSE INTENDED WILL BE AT OWNER'S SOLE RISK AND WITHOUT LIABILITY OR LEGAL EXPOSURE TO WILCOX & BARTON, INC. OWNER SHALL INDEMNIFY AND HOLD HARMLESS WILCOX & BARTON, INC. FROM ALL CLAIMS, DAMAGES, LOSSES AND EXPENSES ARISING OUT OF OR RESULTING THEREFROM.

OWNER

ST. PAUL'S SCHOOL
325 PLEASANT STREET
CONCORD, NH 03301

SITE

ST. PAUL'S SCHOOL
325 PLEASANT STREET
CONCORD, NH 03301
TAX MAP 723Z, LOT 13-1

DRAWING TITLE

PROPOSED RECTORY ROAD GATE PLAN

SCALE

1"=20'

DATE

05/27/2026

DRAFTED BY

KAD

CHECKED BY

KNH

PROJECT MGR

ERL

PROJECT NO.

STPA0004

SHEET NO.

C2

02 OF 02

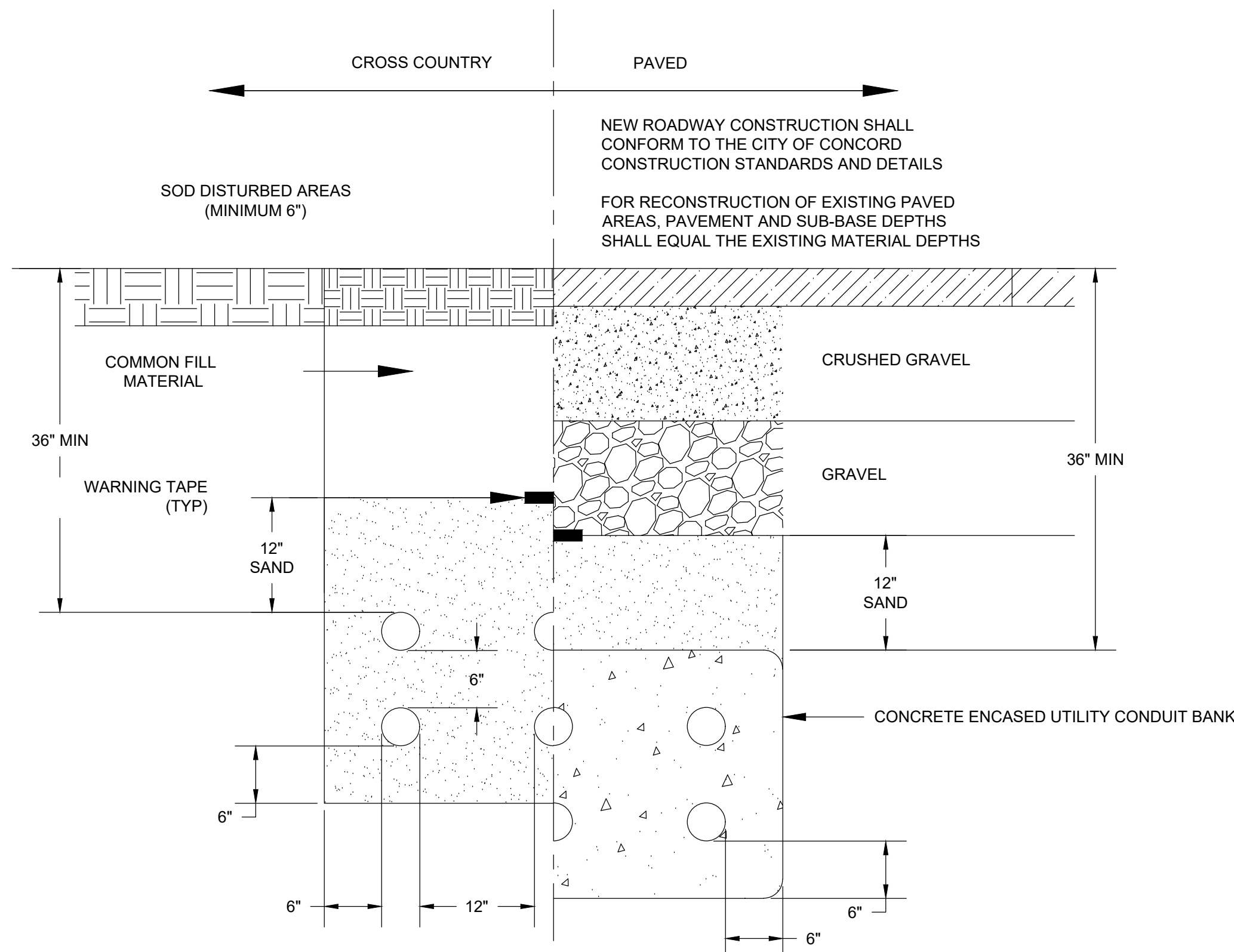
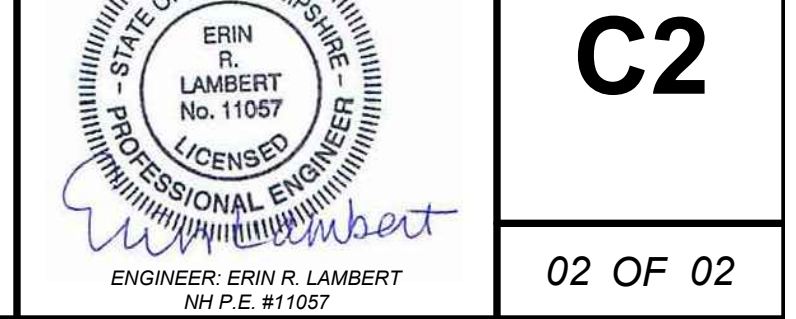

UNDERGROUND CONDUIT INSTALLATIONS SHALL BE COORDINATED WITH ALL LOCAL UTILITIES INCLUDING ELECTRIC, TELEPHONE, GAS, CABLE, STEAM, AND CITY OF CONCORD FIRE ALARM/SIGNAL AND ENGINEERING SERVICES DIVISIONS.

CONDUIT CROSSINGS SHALL BE SWEEPS AT RIGHT ANGLES TO THE STREET. 90° BENDS ARE NOT ACCEPTABLE.

PROPOSED CONDUITS WITHIN PAVED SECTIONS OF STREETS SHALL BE RIGID METAL OR SCH 80 PVC CONDUIT. WHEN THE PROPER DEPTH CANNOT BE ACHIEVED, SCH 40 PVC CONDUIT ENCASED IN CONCRETE SHALL BE USED.

UTILITY CONDUIT DETAIL

NOT TO SCALE

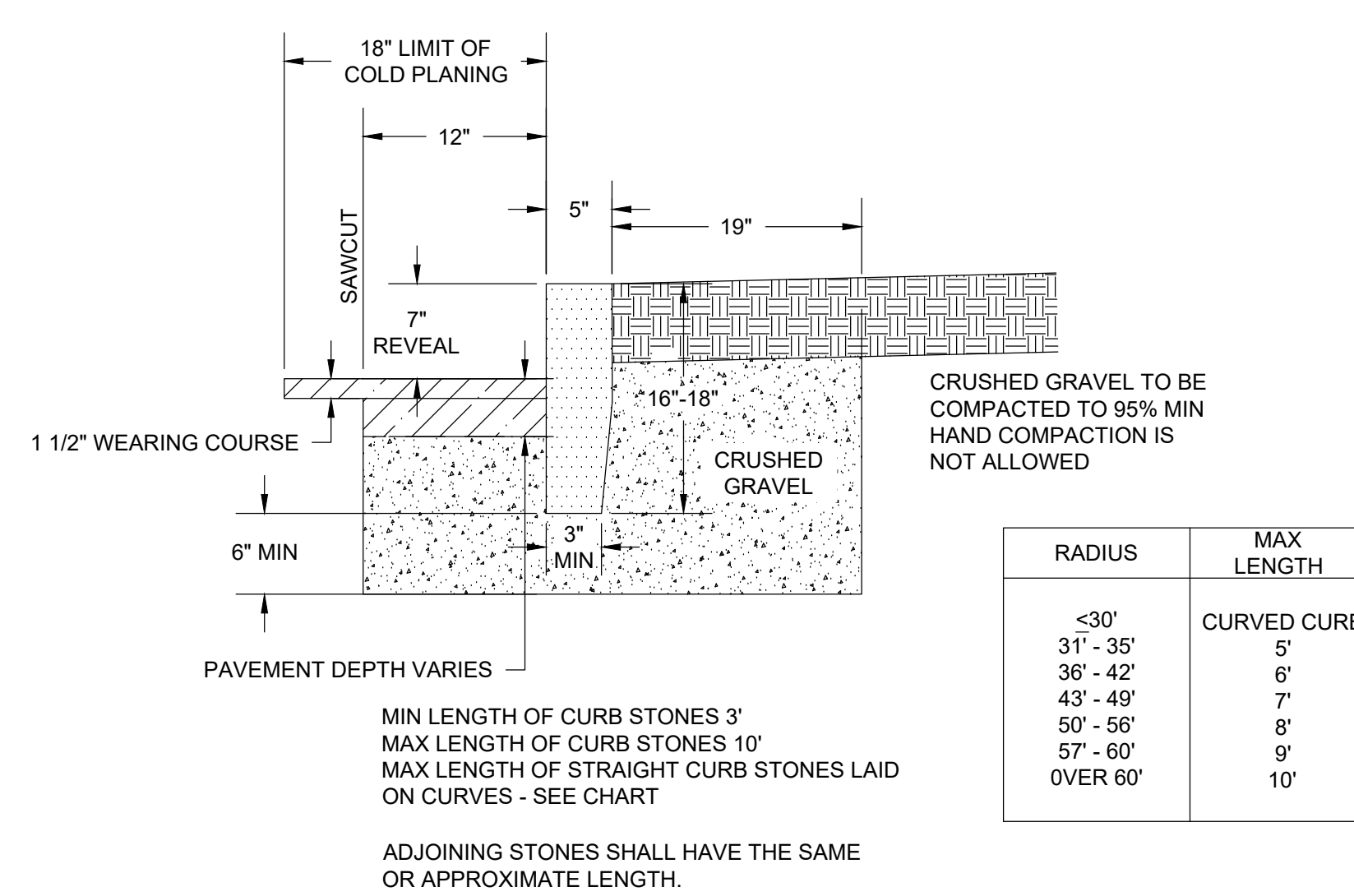

MIN LENGTH OF CURB STONES 3'
MAX LENGTH OF CURB STONES 10'
MAX LENGTH OF STRAIGHT CURB STONES LAID ON CURVES - SEE CHART

ADJOINING STONES SHALL HAVE THE SAME OR APPROXIMATE LENGTH.

FINISH SURFACE AND TOLERANCES FOR VERTICAL GRANITE CURB

AREA	FINISH SURFACE	TOLERANCE
TOP	5" WIDE OR AS OTHERWISE SHOWN, SAWN TRUE PLANE.	+1/8" TO +1/8"
	FRONT AND BACK ARRIS LINES PITCHED STRAIGHT AND PARALLEL.	+1/8" TO +1/8"
FRONT FACE	RIGHT ANGLE TO TOP, APPROXIMATELY TRUE PLANE. NO DRILL HOLES SHOWING IN TOP 10"	+1" TO -1/2"
BACK FACE EXPOSED	PLANE PARALLEL WITH FRONT FACE. STRAIGHT SPLIT TO 1/2" BELOW EXPOSED SURFACE. NO LARGER THAN 1/2" SEGMENT OF DRILL HOLES SHOWING IN ARRIS LINES.	+1" TO -1"
CONCEALED	BELOW 1/2" FROM EXPOSED SURFACE.	+1 1/2" TO -1 1/2"
BOTTOM	APPROXIMATELY PARALLEL TO TOP. MINIMUM WIDTH: 3"	SEE PLANS
ENDS EXPOSED PORTION	SQUARE WITH PLANES OF TOP AND FACE	
JOINTS EXPOSED	OPTIMUM WIDTH: 1"	+3/4" TO -3/4"
CONCEALED	TO BREAK BACK NO MORE THAN 4"	

VERTICAL GRANITE CURB DETAIL

NOT TO SCALE

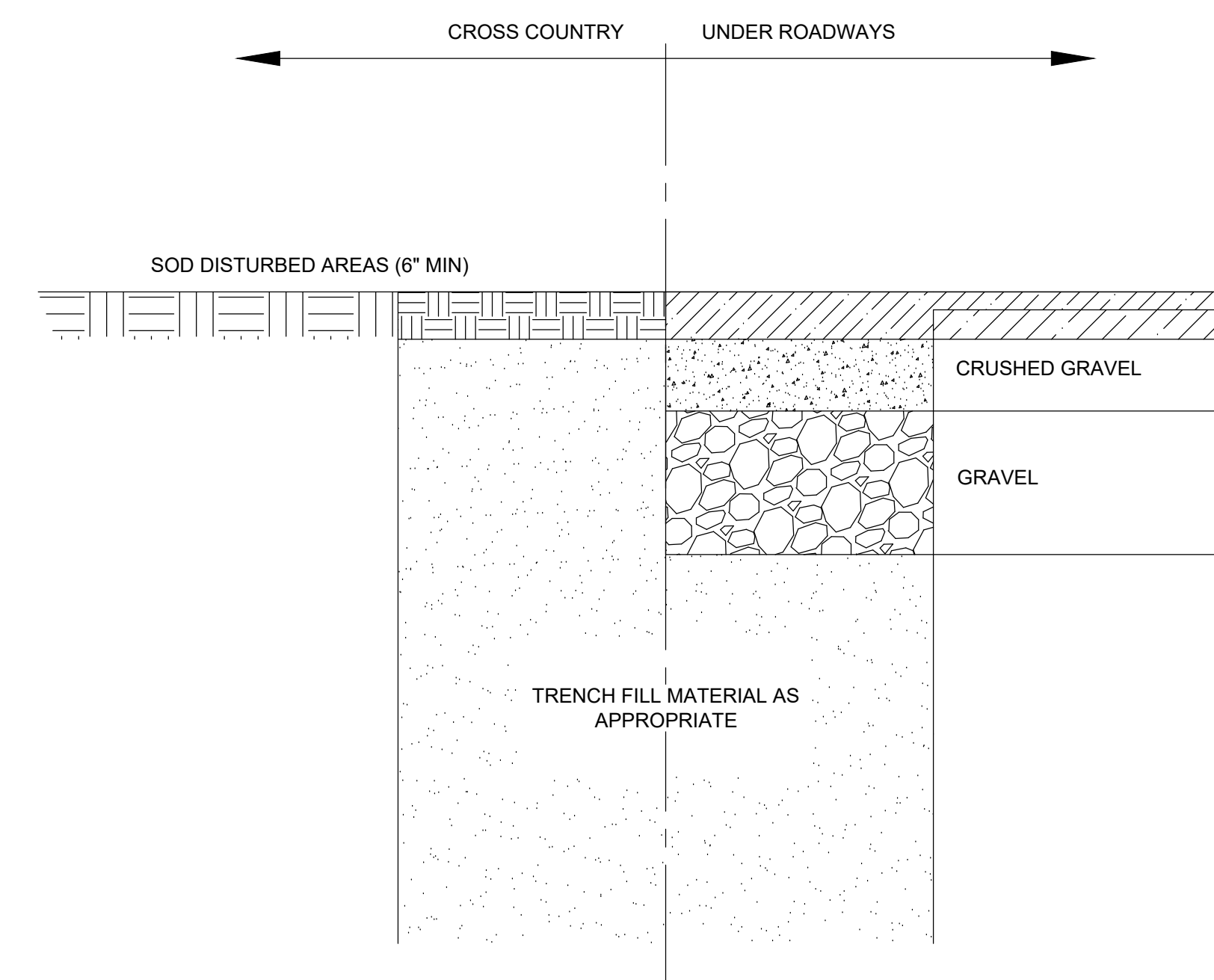

- NEW ROADWAY CONSTRUCTION SHALL CONFORM TO THE CITY OF CONCORD CONSTRUCTION STANDARDS AND DETAILS.
- FOR RECONSTRUCTION OF EXISTING PAVED AREAS, PAVEMENT AND SUB-BASE DEPTHS SHALL MATCH THE EXISTING CONDITIONS WITH NEW MATERIALS.
- THIS DETAIL IS NOT INTENDED TO SHOW THE TRANSITION BETWEEN PAVED AND UNPAVED AT THE EDGE OF ROADWAY.
- MINIMUM PAVEMENT DEPTHS FOR NEW OR RECONSTRUCTED ROADWAYS SHALL BE AS FOLLOWS:

4" (MIN) HOT BITUMINOUS PAVEMENT
1 1/2" WEARING COURSE
2 1/2" BASE COURSE

PAVEMENT REPAIR DETAIL

NOT TO SCALE