

ONE (1) SET OF INTERNALLY ILLUMINATED CHANNEL LETTERS + WIRE WAY



LENS: WHITE ACYLIC
RETURNS: PANTONE 281 C
LENS VINYL: CLIENT SUPPLIED FILL
TRIM CAP: PANTONE 282 C
RACEWAY: PANTONE 696 C

Job Name:
NHRS

Sales Rep:
J. MESSINGER
Drawn By:
J. SANVILLE
Date: 3.13.26

Revision #:
V2- 3.18.26

DATE _____
AUTHORIZED SIGNATURE _____
APPROVED FOR PRODUCTION APPROVED AS NOTED REVISE & RESUBMIT

Design © Advantage Signs, Inc. 2024

Sign Types:

Please review this proof carefully! Spelling and phone numbers are your responsibility. Colors represented in this proof may vary from final product. If color accuracy is important, please notify us prior to approving the design.

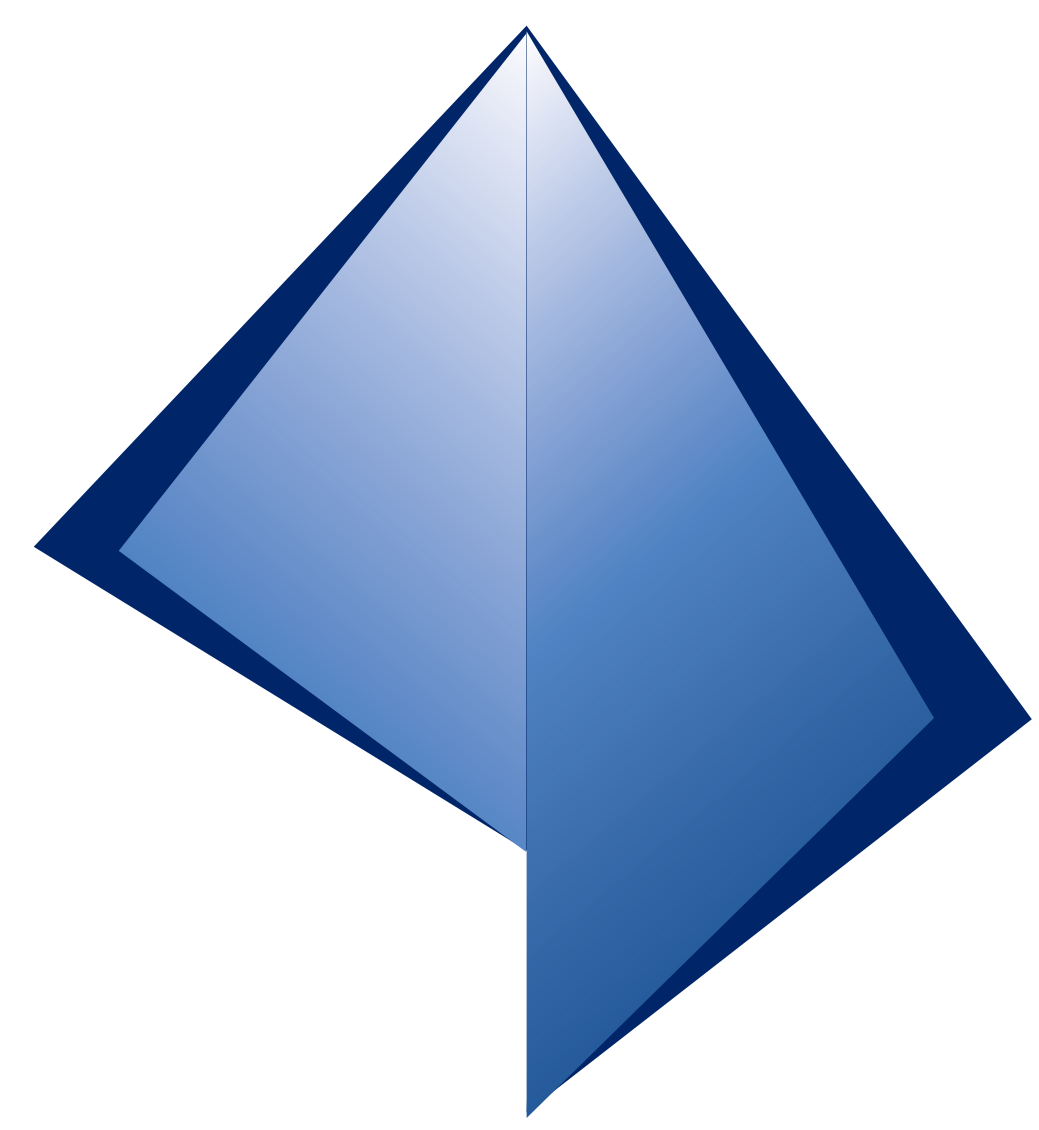
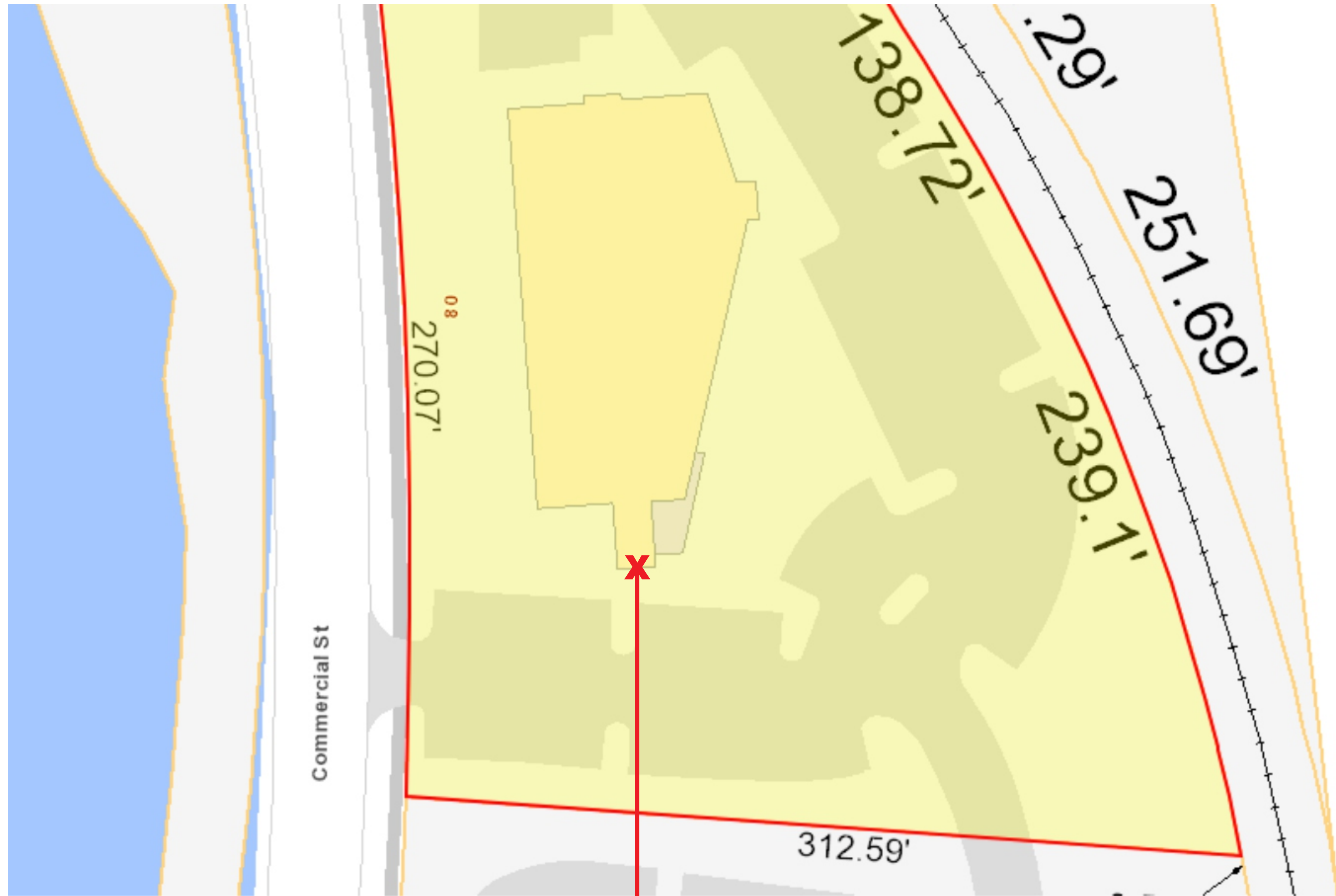

NHRS

Please review this proof carefully! Spelling and phone numbers are your responsibility. Colors represented in this proof may vary from final product. If color accuracy is important, please notify us prior to approving the design.

Job Name:
NHRS

Sales Rep:
J. MESSINGER
Drawn By:
J. SANVILLE
Date: 3.13.26

Revision #:
V2- 3.18.26

Design © Advantage Signs, Inc. 2024

PRODUCTION WILL NOT BEGIN UNTIL SIGNED APPROVALS ARE RECEIVED IN THIS OFFICE

AUTHORIZED SIGNATURE _____
 APPROVED FOR PRODUCTION APPROVED AS NOTED REVISE & RESUBMIT _____ DATE _____

Sign Types: