



CITY OF CONCORD

Code Administration

37 Green Street • Concord, New Hampshire 03301 • 225.8580 • Fax 225.8586

APPLICATION TO ERECT A SIGN

Permit # _____

1) Address where sign is to be erected: 189 NORTH MAIN STREET

2) **Message as shown on sign:**
189 NORTH MAIN STREET plus space for commercial tenants

	<u>Property Owner Information</u>	<u>Sign Installer Information</u>	<u>Sign Owner Information</u>
Name >	JARBEL REALTY LLC	FIRST SIGN & CORPORATE IMAGE, INC.	KELLEY FAMILY PROPERTIES
Address >	PO BOX #1374	107 HOLLIS STREET	PO BOX #1374
City/State/ Zip >	CONCORD, NH 03301	MANCHESTER, NH 03101	CONCORD, NH 03301
Phone(s) >	231-1240	627-0003	231-1240
E-mail >	ben@kelleyfamilyproperties.com	info@firstsignnh.com	ben@kelleyfamilyproperties.com

4) Property Information: CU Zone | 45' Store/Building Frontage | 105' Lot Frontage | ft

5) Type of Sign: New Relocation Replacement
 Freestanding Monument
 Wall Projecting Window Awning Roof Marquee Marker

5) Materials to be used: STEEL, ALUMINUM, ACRYLIC, GRANITE

6) How & to what is sign supported: EXISTING GRANITE BASES

7) Dimensions of sign: 3'-8" Length x 4'-7" Height = 17 Total (Round up) sf

8) Height Overall: Ground to bottom of sign 1'-9" ft | Ground to top of sign 6'-4" ft

9) Illumination: None External Internal **Internally illuminated signs are NOT permitted in CVP, IS, UT or any Residential Zones**

10) Does sign project over public property or sidewalk? No Yes* > _____ ft in

11) How far back is leading edge of sign from any curb face? 1.5'

NOTE: Any applicant for a permit to locate a projecting sign over a public right-of-way, in accordance with this Ordinance, shall file with the Code Administrator, a certificate of insurance indemnifying the City of Concord against any form of liability in a minimum amount as specified by the Finance Director. No permit shall be issued prior to the receipt of said certificate and the permit shall be valid only so long as the certificate remains in effect. The policy shall provide for advance notification to the Code Administrator in the event of cancellation. If the policy should lapse or be cancelled, the applicant shall remove the sign immediately. (Article 28-6-11.a)

12) Does the sign require Design Review? *Yes No Historic District Review? Yes No

*Design review is **required** per Article 28-6-9.f, if any of the following apply:

- I. The sign is to be located in a Performance (P) District
- II. The Development requires Major Site Plan Review, Article 28-9-4.d.1
- III. The sign area is greater than the maximum in Column 1 of Table 28-6-9.a
- IV. The sign is the second or third freestanding sign on a lot.

RECEIVED
JUL 23 2021

Continued on back →

NOTE:
MASTER SIGN
REQUEST

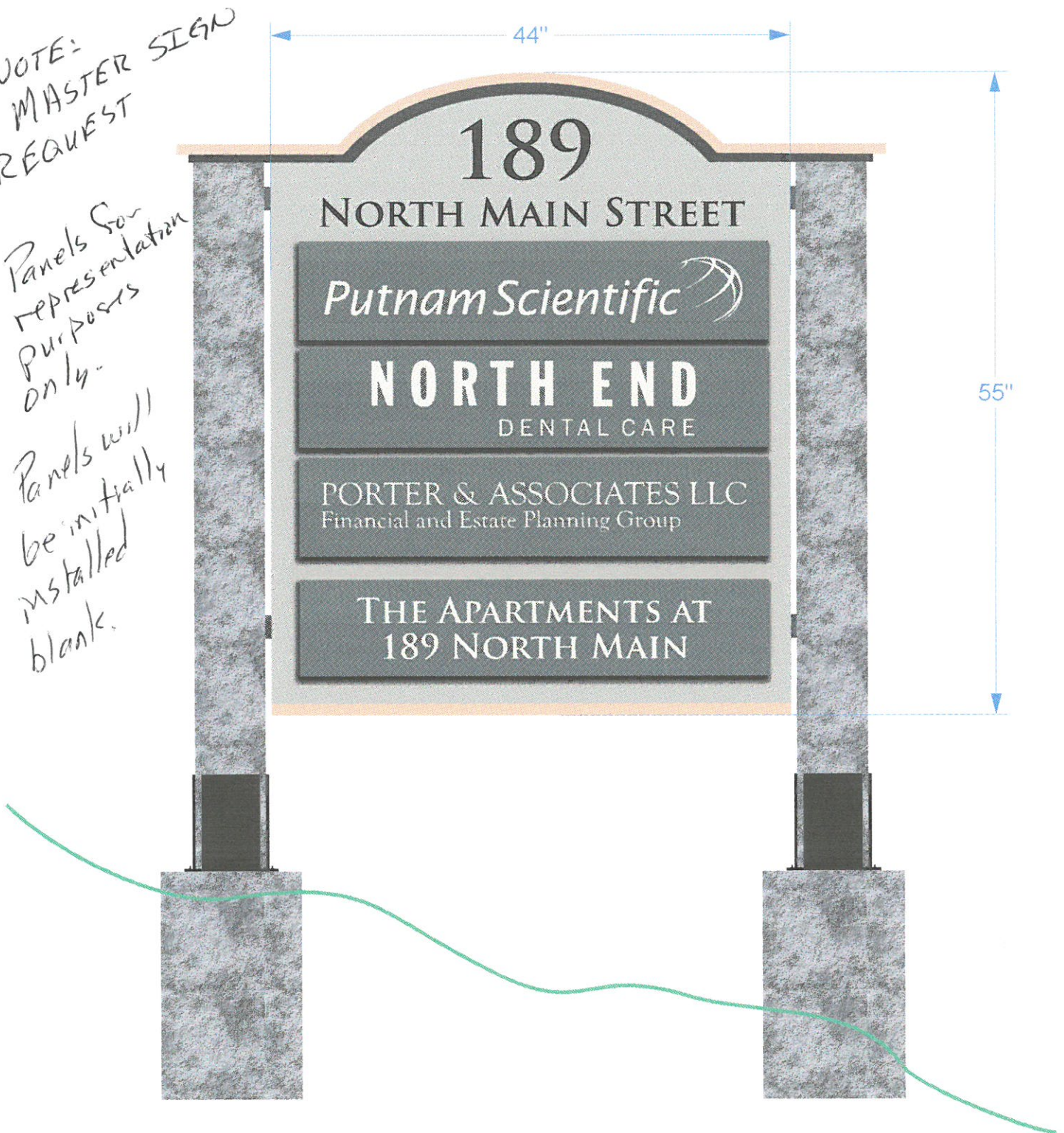

Panels for
representation
purposes
only.

Panels will
be initially
installed
blank.



Freestanding sign

Double-sided; tenant panels for commercial offices;
Raised "189 North Main Street"; flat "The Apartments at 189 North Main";
Granite posts set on existing granite blocks

	Iron Mountain
	Rockport Gray

Date: 06/17/2021

Scale: 1" = 1'-0"

FIRST
SIGN INC.

107 Hollis Street | Manchester, NH 03101 | 603-627-0003



photos of 2 existing granite bases

**FIRST
SIGN** INC.

Date:

Scale:

107 Hollis Street | Manchester, NH 03101 | 603-627-0003

This drawing is the property of First Sign & Corporate Image, Inc. Any duplication or use without the prior written consent is punishable by law.

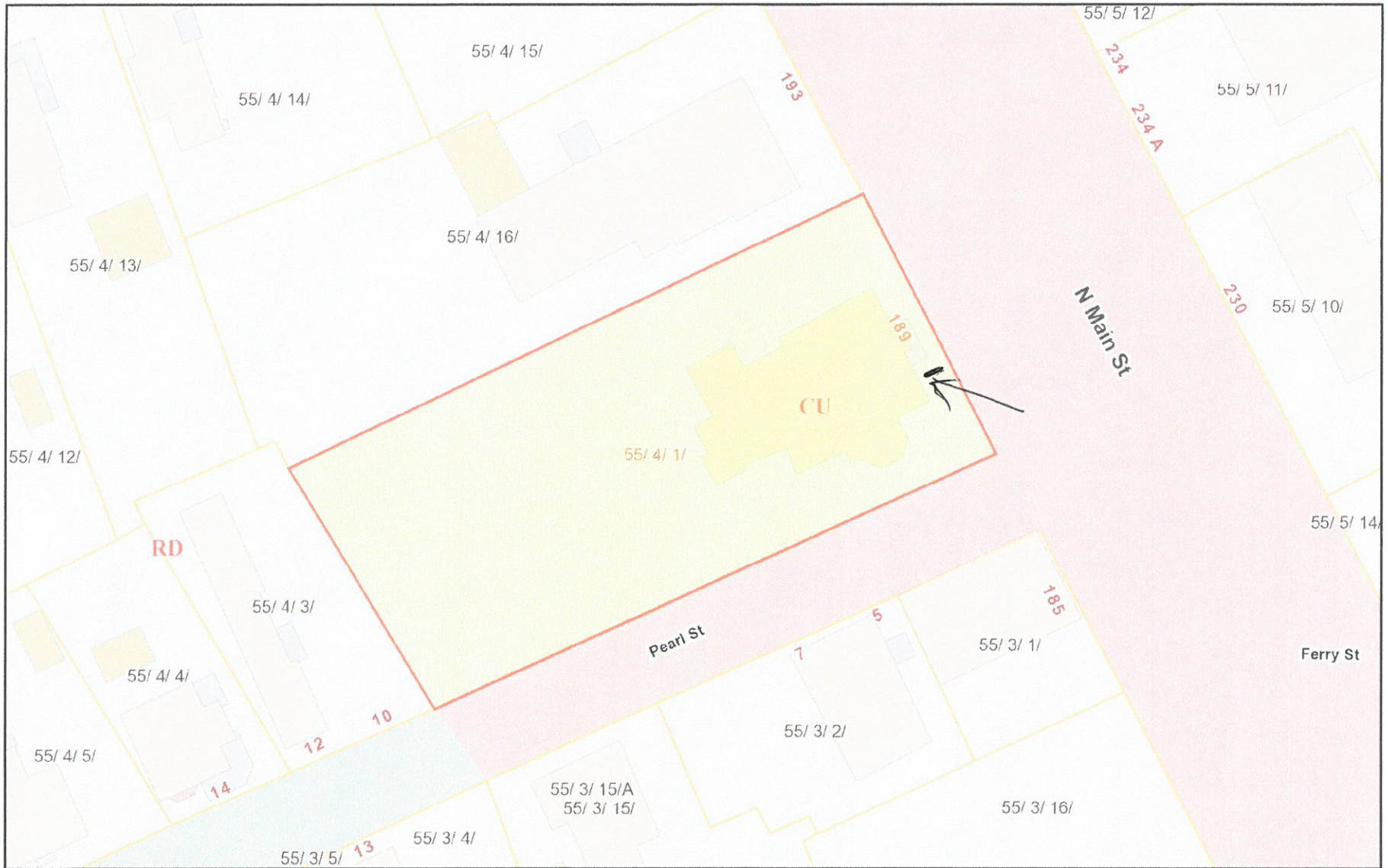

June 23, 2021

