

**FACT SHEET**

41703 Concord-Hopkinton, I-89 Bridge Painting

41706 Concord-Ashland, I-93 Bridge Painting

**Proposed work:** The Department proposes with low-bid contracts to paint state-owned steel beam bridges in Concord on I-89 and I-93. The work will meet environmental protection and lead-bearing paint removal regulations. All steel beams will be repainted.

Site 1 is I-89 NB, SB over NH 13 (Clinton Street) at Exit 2. (photo 1, 2)

Site 2 is Hoit Road over I-93 NB, SB at Exit 17. (photo 4, 5)

**Time Frame:** The projects are scheduled to advertise in Sept 2020; the work is anticipated during 2021 with completion by December 2021. Lane closures are limited to 8-10 weeks at each site.

**Traffic Impacts:** See *Traffic Control Supplemental Info sheets* (attached)

- The Contractor is required to work from a lane-closure work-zone.
- Site 1 - There are no impacts to I-89 traffic.
- Site 1 - NH 13 (Clinton St) will maintain two-way traffic (one lane each direction) on NH 13 at all times while providing a lane-closure work zone. NH 13 lane closures are restricted to night hours (8pm-6am) for 8-10 weeks during period April 1 thru December 1. Lanes to be cleared after each work shift.
- Site 2 I-93 lane closures are restricted to night hours (9pm-6am) for 8-10 weeks during period Apr 1-Dec 1 (NB Sun pm thru Fri am; SB Mon pm thru Fri am). Maintain one lane traffic (min.).
- Site 2 I-93 Close off ramps during the night closure of the low-speed lane at SB Exit 17E and NB Exit 17.
- Site 2 - Hoit Rd will maintain two WB lanes and one EB at all times while closing the EB right lane as a work zone 24/7 protected with concrete barrier.
- Site 2 - Hoit Rd will reduce speed limit from 45 mph to 35 mph.
- Site 2 Add stop sign on SB Exit 17E Ramp at Hoit Road EB.

**Containment:** All lead-bearing paint chips, abrasive debris, and dust generated during paint removal operations will be contained and collected within air-tight, sealed enclosures to protect the environment, the public, and adjacent properties (photos 3, 6).

**Work Hours:** Work involving Interstate lane closures is required during night hours (I-89 8pm-6am; I-93 9pm-6am). Work involving noise on other spans is limited to daytime hours (7am-7pm).

**Painting:** All steel bridge beams will be blast cleaned and repainted with three coats of a non-lead, high-performance paint used on many NH bridges. The finish color will be dark brown. Contractors are pre-qualified and certified for large industrial and lead-containing paint removal projects. All work is subject to full-time Department quality assurance inspection and approval.



**41703 Bundle 3 / Site 1 / Bridge 1-2** **Concord** I-89 over **Clinton St** at Exit 2 (MM 2.10)

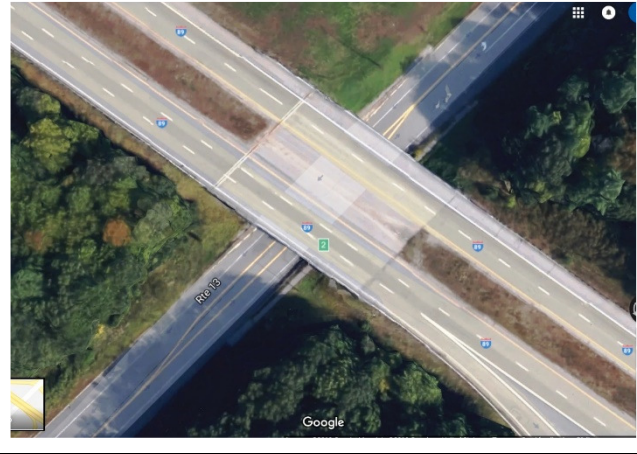

**Site 1 Bridge 1-2** at Exit 2  
 Br No 182/055 I-89 NB over NH 13, Clinton St  
 Br No 181/055 I-89 SB over NH 13, Clinton St  
 I-89 Traffic: 23,533 NB/ 24,601 SB vpd (2019)  
 NH 13 Speed: 35 mph  
 NH 13 Traffic: 6,067 EB/5,794 WB vpd (2019)  
 NH 13 Travel width 6-12-12-6 (3 lanes)  
 NH 13 Pavement width 48 ft  
 Sidewalk (span 1 & 3): 4 ft  
 Bridge width (o-o) NB, SB: 117'-10"  
 3-span bridge: 44 ft / 54 ft / 44 ft = 142 ft

**Proposed Work**  
 -Use truck-mounted rapid deployment over NH 13 pavement (span 2) in lane-closure work zone.  
 -Locate support vehicles on NH 13.  
 -NH 13 clear lanes at the end of the work shift.  
 -Spans 1- Use suspended platform (stays 24/7).  
 -Spans 3- Use suspended platform (stays 24/7).  
**Traffic**  
 -I-89 No impact to traffic.  
 -NH 13 maintain one lane each WB, EB traffic.  
 -NH 13 maintain sidewalk opposite closure.



(sample photo of proposed)

**NH 13 Lane closures:**  
 -Lane closures are restricted to night hours (8 pm-6 am) during period April 1 to Dec 1.  
**Duration:**  
 -Overall duration of lane closures: 6-8 wks  
**Channel traffic:**  
 -Use drums, cones, flaggers, officers

41703 Bundle 3 / Site 1 / Bridge 1-2

Concord I-89 over Clinton St at Exit 2

(MM 2.10)

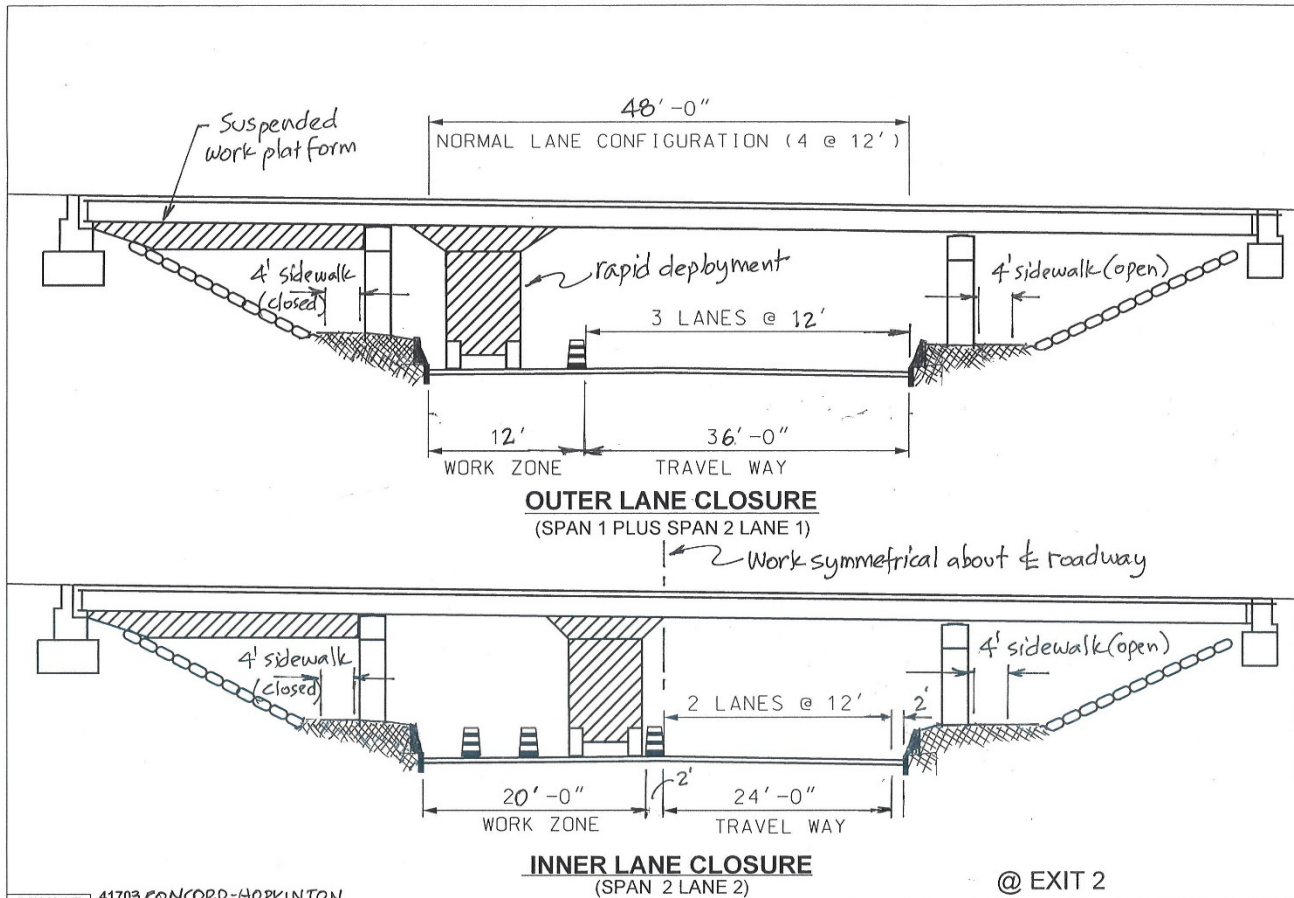

DGN. NAME	41703 CONCORD-HOPKINTON
SAVED VIEW	BRIDGE PAINTING
DIRECTORY	I-89 OVER NH 13 @ EXIT 2: BUNDLE #3 BRIDGES 1-2

STATE OF NEW HAMPSHIRE			
DEPARTMENT OF TRANSPORTATION - BUREAU BRIDGE DESIGN			
FEDERAL PROJECT NO.	STATE PROJECT NO.	SHEET NO.	TOTAL SHEETS
	41703		

@ EXIT 2



(Similar work at I-93 Exit 23 Meredith (2020))

41703 Bundle 3 / Site 1 / Bridge 1-2 Concord I-89 over Clinton St at Exit 2 (MM 2.10)



**41706 Bundle 6 / Site 1 / Bridge 1 Concord Hoit Road over I-93 at Exit 17 (MM 44.58)**

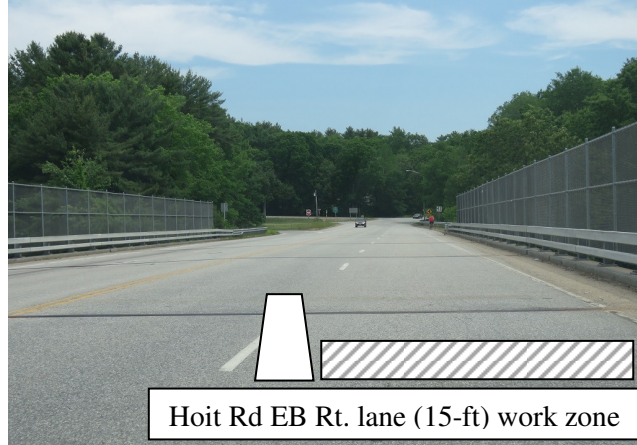

Hoit Rd EB Rt. lane (15-ft) work zone

**Site 1 Bridge 1** at Exit 17  
 Br No 041/123 Hoit Road over I-93 NB, SB  
 I-93 Traffic **24,248** NB / 24,447 SB vpd (2019)  
 I-93 Speed / Hoit Rd: 65 mph / 45 mph  
 Hoit Rd Traffic: **10,785** vpd (2019)  
 Hoit Rd Travel width (**four** 12-ft lanes) = **48 ft**  
 Hoit Rd Shoulders: 5'-6"  
 Hoit Rd Pavement width **59-ft**  
 Bridge width (out-to-out): 62.5 ft  
 5-span bridge: 35.5 / 60 / 60 / 60 / 35.5 = 251 ft

**Proposed Work**  
 -Use truck-mounted **rapid deployment** over I-93 pavement (span 2, 4) in lane-closure work zone.  
 -I-93 **clear** lanes at the end of the work shift.  
 -Other spans- **suspended platforms** (stays 24/7)  
 -**Support** units on **overpass EB Rt. lane (24/7)**  
 -May locate support vehicles in SW infield (X)  
 -May locate support vehicles in median (span 3)  
**Traffic**  
 -I-93 maintain **one lane** traffic (min.)  
 -Hoit Rd **maintain two lanes WB** and **one EB**.  
 -Hoit Rd work zone reduce speed to 35mph



**I-93 lane closures:**  
 -I-93 NB, SB lane closures are restricted to **night** hours (**9 pm-6 am**) for **8-10 wks** during period **Apr 1-Dec 1**:  
 -NB Sunday pm thru Friday am;  
 -SB Monday pm thru Friday am  
 -**Close off-ramps** with closure of low-speed lane at SB Exit 17E & NB Exit 17. **Detour** to next exit.  
**Channel traffic:**  
 -Use drums, cones, flaggers, officers, attenuator  
 -**Concrete barrier** for **24/7** Hoit Rd EB right lane closure with attenuator both ends  
 -Add **stop sign** on SB Exit 17E Ramp at Hoit Rd EB

Rapid Deployment on Interstate- (night)  
 Support vehicles on overpass EB Rt. lane (24/7)

41706 Bundle 6 / Site 1 / Bridge 1

Concord Hoit Road over I-93 at Exit 17

(MM 44.58)



SW Infield



NB



Median



NB



Median



41706 Bundle 6 / Site 1 / Bridge 1 Concord Hoit Road over I-93 at Exit 17 (MM 44.58)

